

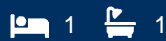

**morton.**

**Chippendale** 708/5 Park Lane



With respect to the government's restrictions around open homes and to help stop the spread of COVID-19, our properties can be viewed by appointment only. Please submit an online enquiry or contact the listing agent for more information.

Located in the near new 5 star Central Park complex, this fully furnished one bedroom apartment offers executive life style with convenience. Features include:

- Sleek modern kitchen with gas cooking and dishwasher
- Enclosed alfresco style balcony, perfect for all year round use.
- Carpeted main bedroom and with built ins.
- Over sized en suite bathroom and separate internal laundry with washing

**View**

As advertised or by appointment

**Agent**

**Sarah Fowell**

📞 0437 492 129

✉ sarah@morton.com.au

**morton.com.au**



The interior style and design of this floor plan is designed for inspiration purposes to show the living spaces. It is not an exact replica of the furniture and fittings in the home.

Produced by **DIAKRIT**

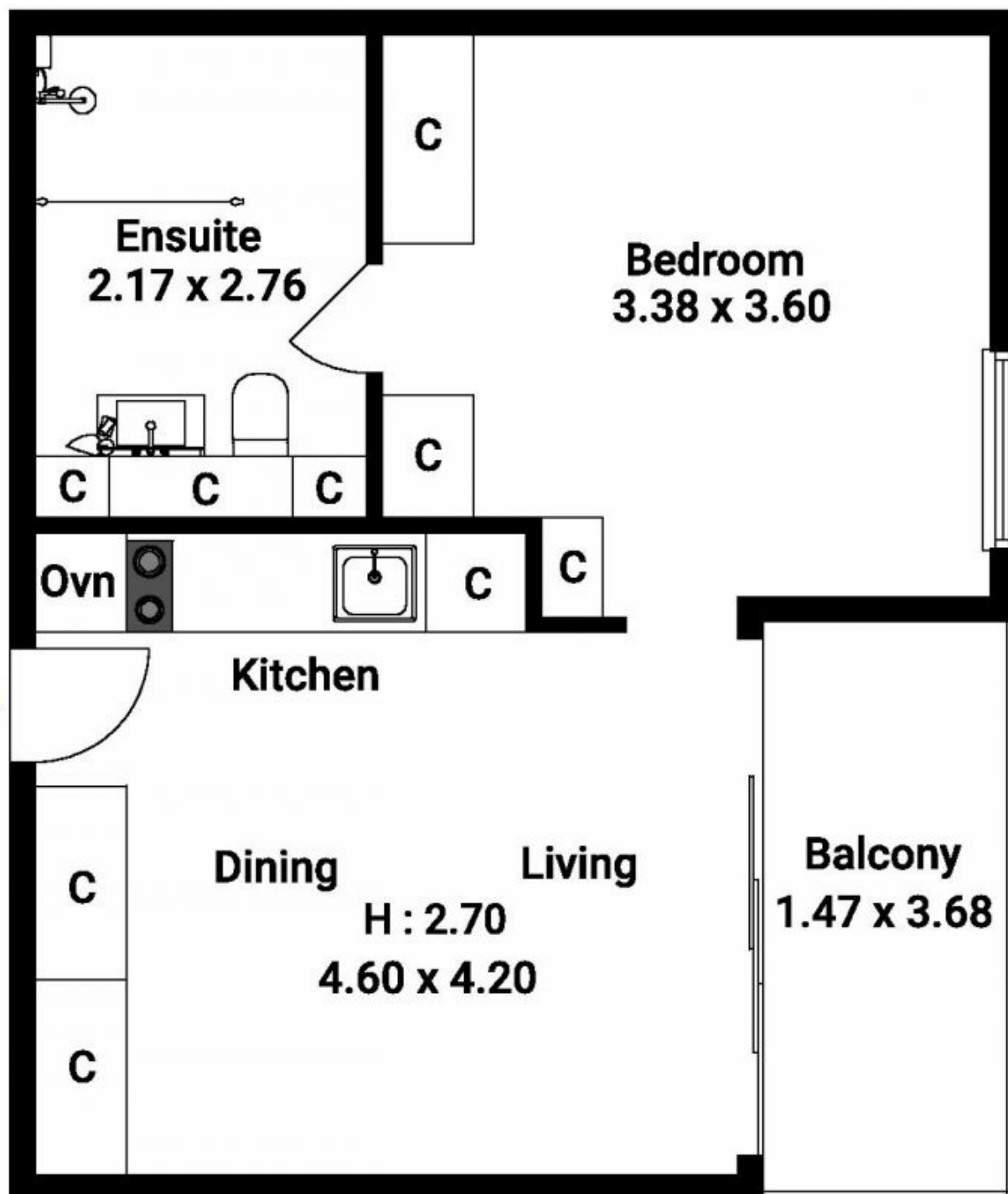

The floor plan is not to scale. Measurements are indicative and in metres.