



# morton.

**Penrith** 212/60 Lord Sheffield Circuit

 1  1  1

With respect to the government's restrictions around open homes and to help stop the spread of COVID-19, all inspections are to be conducted as private appointments only with strict social distancing and hygiene protocols adhered to. Please contact the listing agent for more information.

A sleek easy-living apartment stylishly appointed for executive living, this designer Wildwood Apartments residence is positioned in the highly acclaimed Thornton Estate master-planned community. Crisp, contemporary and featuring sweeping urban views, it captures the essence of style and quality with ultra-modern finishes, good natural light and a great sense of privacy.

- Fresh and airy open design with timber flooring
- Good sized double bedroom with built-ins plus a separate study
- Covered balcony that captures elevated views over the area
- Quality gas kitchen featuring sleek fittings and dishwasher
- Well-proportioned designer bathroom plus internal laundry



[morton.com.au](https://www.morton.com.au)

### View



As advertised or by appointment

### Agents

#### Anthony Fleming

 0437 929 484  
 [anthonyf@morton.com.au](mailto:anthonyf@morton.com.au)

#### Michelle Roberts

 0447 181 067  
 [micheller@morton.com.au](mailto:micheller@morton.com.au)



# SHEFFIELD QUARTER

THORNTON

## ONE BEDROOM + STUDY APARTMENT

UNIT 2.12 LOT 34 (A)  
 UNIT 3.12 LOT 49  
 UNIT 4.12 LOT 64  
 UNIT 5.12 LOT 79

INTERNAL AREA: 53 m<sup>2</sup>  
 EXTERNAL AREA: 11 m<sup>2</sup>

TOTAL: 64 m<sup>2</sup>

PARKING: 1

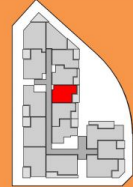

URBAN CBRE



All apartments subject to contract and availability. Images showing the building, interiors and views are computer generated prior to construction and indicative only. Dimensions, layout, finishes and specifications are subject to change and may differ from those shown. Views differ between apartments. Ground floor retail not yet confirmed. Furniture and plantings are for decorative purposes and are not included.