



**morton.**

**Penrith** 525/1-39 Lord Sheffield Circuit

 2  2  1

With respect to the government's restrictions around open homes and to help stop the spread of COVID-19, our properties can be viewed by appointment only. Please submit an online enquiry or contact the listing agent for more information.

Convenience, community and sophisticated living combine for an amazing lifestyle with this quality 'Harts Landing' apartment. Situated within the master-planned Thornton Estate, it brings light, space and privacy to its list of many highlights and provides a well-designed living space with elevated outlooks that stretch to the Blue Mountains.

Features include:

- Smart and stylish layout featuring 85sqm of living space
- Sun-filled open design with timber-look porcelain floors
- Reverse-cycle air conditioning in the living area
- Two double-sized bedrooms plus separate study area
- Bright north east facing balcony with sweeping views
- Gas fitted kitchen with designer finishes and dishwasher

**View**

As advertised or by appointment

**Agent**

**Amy Torbarina**

 0438 977 172

 amy@morton.com.au

**morton.com.au**



## BUILDING A

### LEVEL 5

#### APARTMENT A525 LOT 52

2 BEDROOM + STUDY

INTERNAL AREA	70m <sup>2</sup>
EXTERNAL AREA	12m <sup>2</sup>
<b>TOTAL</b>	<b>82m<sup>2</sup></b>

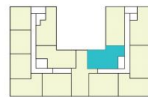

Disclaimer: This floor plan has been prepared for marketing purposes only. All descriptions, dimensions, depictions and other details in this floor plan may not be to scale and may vary from the property as built. Your attention is drawn to the special conditions of the contract for sale of land. No third party has any authority to make or give any representation or warranty in relation to the property unless the representation or warranty is confirmed by the vendor and included in the contract for sale of land. Revised floor plans - 14.08.18

**CALL 1300 548 588**  
**HARTSLANDING.COM.AU**  
 LORD SHEFFIELD CIRCUIT, PENRITH  
**LINK DISPLAY SUITE**  
 22 GADIGAL AVENUE, ZETLAND

PROUDLY DEVELOPED BY **PAYCE** SALES BY **LINK**

