



**morton.**

**Redfern** 125 Marriott Street

 2  1  1

With respect to the government's restrictions around open homes and to help stop the spread of COVID-19, our properties can be viewed by appointment only. Please submit an online enquiry or contact the listing agent for more information.

A peaceful and private haven in a vibrant urban village setting, this spacious two-bedroom home is surrounded by some of Sydney's best restaurants and cafes in a leafy heritage-rich precinct only a few km's to the CBD.

Consisting of elegant interiors, quality finishes and a layout that captures the essence of inner-city sophistication in this renovated Victorian terrace.

- Spacious separate living and dining spaces
- Elegant kitchen with ample storage and benchspace
- 2 large bedrooms, master with built-ins
- Bathroom features bathtub and separate toilet
- Internal laundry with ample storage

**morton.com.au**

**View**

As advertised or by appointment

**Agent**

**Sarah Fowell**

 0437 492 129

 sarah@morton.com.au

Baptist Lane

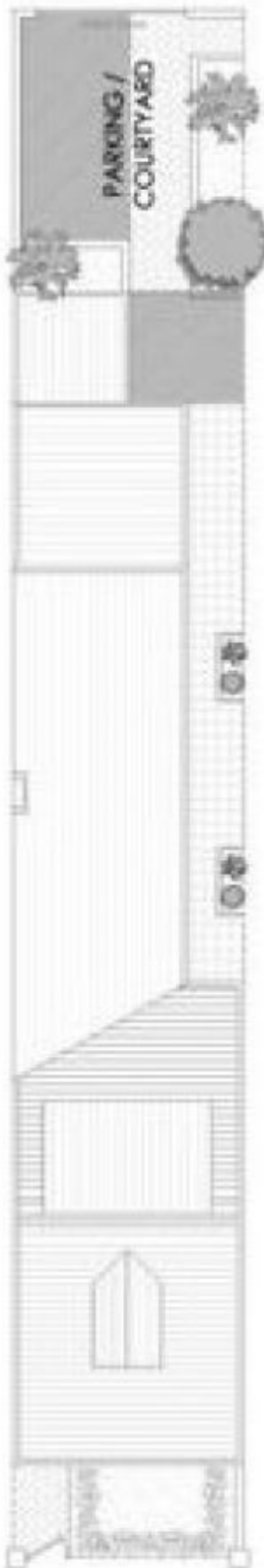

MARRIOTT STREET



LEVEL 1



LEVEL 2



SCALE (METRES)

PLANS SHOWN ARE ONLY INDICATIVE OF LAYOUT. DIMENSIONS ARE APPROXIMATE

All information contained herein is gathered from sources we believe to be reliable, however we cannot guarantee its accuracy and interested persons should rely on their own enquiries. Dimensions are approximate.

Approximate Area:

Internal Floorpace:	77m <sup>2</sup>
Balconies, Courtyards, Gardens & Store:	61m <sup>2</sup>
Total:	138m <sup>2</sup>

