



**morton.**

**Wentworth Point** B9030/11 Bennelong Parkway

 2  2  1

#### ENTRY LOCATED ON AMALFI DRIVE

With respect to the government's restrictions around open homes and to help stop the spread of COVID-19, our properties may be viewed by appointment only and only 1 person may inspect at a time. Please submit an online enquiry or contact the listing agent for more information.

Great opportunity to lease this apartment in Building Bari at One The Waterfront, an iconic development in Wentworth Point. One the Waterfront offers a unique luxury lifestyle with high end indoor and outdoor facilities to entertain you all year round. Located at the foot of Wentworth Point, it is in easy access to transport services to Rhodes, Parramatta and Circular Quay.

#### Apartment features:

- Large entertainer's balcony
- Generous open plan design with latest in décor finishes
- Quality designer kitchen with Bosch built- in appliances

**morton.com.au**

#### View

As advertised or by appointment

#### Agent

**Nevena Petrovic**

 0428 835 910

 nevena@morton.com.au

BUILDING  
ONE B



Disclaimer: This plan is a guide only and does not constitute an offer or contract. Please note changes may be made during the development and sales. Fittings, fixtures and specifications are subject to change without notice to conform with the terms of the contract of sale. All parties must rely on their own investigation to validate this information as it is not guaranteed. No liability will be accepted for any misreading or misinterpretation. (Date Issued 01/10/13)

# ONE

THE WATERFRONT

APARTMENT | LOT  
**9030 | 68**

2 Bed + 2 Bath + Study

INTERNAL 78m<sup>2</sup>  
EXTERNAL 10m<sup>2</sup>  
**TOTAL 88m<sup>2</sup>**

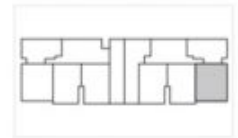

BUILDING ONE B LEVEL 9

ONE THE WATERFRONT DISPLAY CENTRE  
Shop 4E, The Piazza, 21 Bennelong Parkway  
Wentworth Point NSW 2127  
1300 865 465 [onethewaterfront.com.au](http://onethewaterfront.com.au)

DEVELOPED BY **PIETY THP** SALES BY **LINK**