



morton.

Ermington 823/68 River Road

 2  2  1

Located in the riverside urban hub of Royal Shores, this apartment located in the Seamist building offers waterside community lifestyle within the master-planned development in family friendly Ermington. Perched on the waters edge, Royal Shores offers easy access to the Parramatta River, riverside walkways and cycleways, and recreational parks designed to entertain all ages. You'll be spoiled for peaceful living in this cosy resort-like corner of Sydney.

Property features include:

- Rare open plan living with high ceiling
- Open plan living and dining flowing to versatile entertainer's winter garden
- Double galley kitchen with stainless steel appliances, stone bench tops
- Modern timber look tile throughout living area
- Reverse cycle air conditioning
- Data/TV points in living and main bedroom
- Security access building with audio-video intercom
- Secure car space and storage cage

morton.com.au

View

As advertised or by appointment

Agent

Nevena Petrovic

 0428 835 910

 nevena@morton.com.au

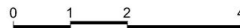

JOINTLY DEVELOPED BY



Disclaimer: This floor plan has been prepared for marketing purposes only. All descriptions, dimensions, depictions and other details in this floor plan may not be to scale and may vary from the property as built. Your attention is drawn to the special conditions of the contract for sale of land. No third party has any authority to make or give any representation or warranty in relation to the property unless the representation or warranty is confirmed by the vendors and included in the contract for sale of land. Date Issued: 03/10/14 Revision: A

SALES BY



ROYAL SHORES
SYDNEY HARBOUR

SEAMIST
APARTMENT 823
LOT 210

2 BEDROOM

Internal (including Winter Garden)	99 sqm
Total	99 sqm

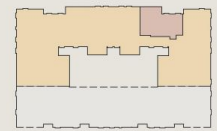

SEAMIST - LEVEL 8

ROYAL SHORES DISPLAY CENTRE
1 Bundarra Street, Ermington NSW 2115
P 1300 888 558 W royalshores.com.au