



# morton.

**Penrith** 11/60 Lord Sheffield Circuit

 1  1  1

A sleek easy-living apartment stylishly appointed for executive living, this designer Wildwood Apartments residence is positioned in the highly acclaimed Thornton Estate master-planned community. Crisp, contemporary and featuring sweeping urban views, it captures the essence of style and quality with ultra-modern finishes, good natural light and a great sense of privacy.

- Fresh and airy open design with timber flooring
- Good sized double bedroom with built-ins plus a separate study
- Covered balcony that captures elevated views over the area
- Quality gas kitchen featuring sleek fittings and dishwasher
- Well-proportioned designer bathroom plus internal laundry
- Security basement car space, air-conditioning and intercom entry
- Access to the community park plus a rooftop BBQ terrace

### View

As advertised or by appointment

### Agent

**David Lipman**

 0409 663 535

 david@morton.com.au

[morton.com.au](http://morton.com.au)



# SHEFFIELD QUARTER

THORNTON

ONE BEDROOM  
APARTMENT

UNIT G.11 LOT 11(A)

INTERNAL AREA: 51 m<sup>2</sup>  
EXTERNAL AREA: 8 m<sup>2</sup>

TOTAL: 59 m<sup>2</sup>

PARKING: 1

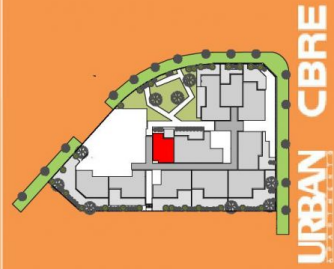

All apartments subject to contract and availability. Images showing the building interiors and views are computer generated prior to construction and indicative only. Dimensions, layouts, finishes and specifications are subject to change and may differ from those shown. All dimensions are to the internal face of walls unless otherwise confirmed. Furniture and plantings are for illustrative purposes and are not included.

