



morton.

Sydney 1008/61 Macquarie Street

🏠 1 🚗 1 🚗 1

Perched high on level 10 and spanning across 94m², this expansive oversized one-bedroom apartment is the first of its kind to come to the market in a number of years. Featuring premium Circular Quay views towards the magnificent arches of the Harbour Bridge, this residence stamps itself in the highest echelon of Sydney CBD property. Sundrenched throughout and with fantastic living spaces, this home will suit both the astute investor or those simply wanting their own slice of elegance and luxury with the option for complete transformation.

- Wider Panel Living and Entertainment space
- Private Residential living, investment or hotel lease options
- The highest level offering of only 7 similar floorplans.
- Panoramic West Facing Views across the harbour
- Spacious master has built-ins, ensuite, balcony access
- Stones throw to CQ Station and light rail, direct line to the airport
- Gym, spa, sauna, pool and hotel trained 24-hr concierge

morton.com.au

View

As advertised or by appointment

Agents

Ettiene West

📞 0410 593 749
✉ ettiene@morton.com.au

Emma Ryan

📞 0409 325 440
✉ emmar@morton.com.au

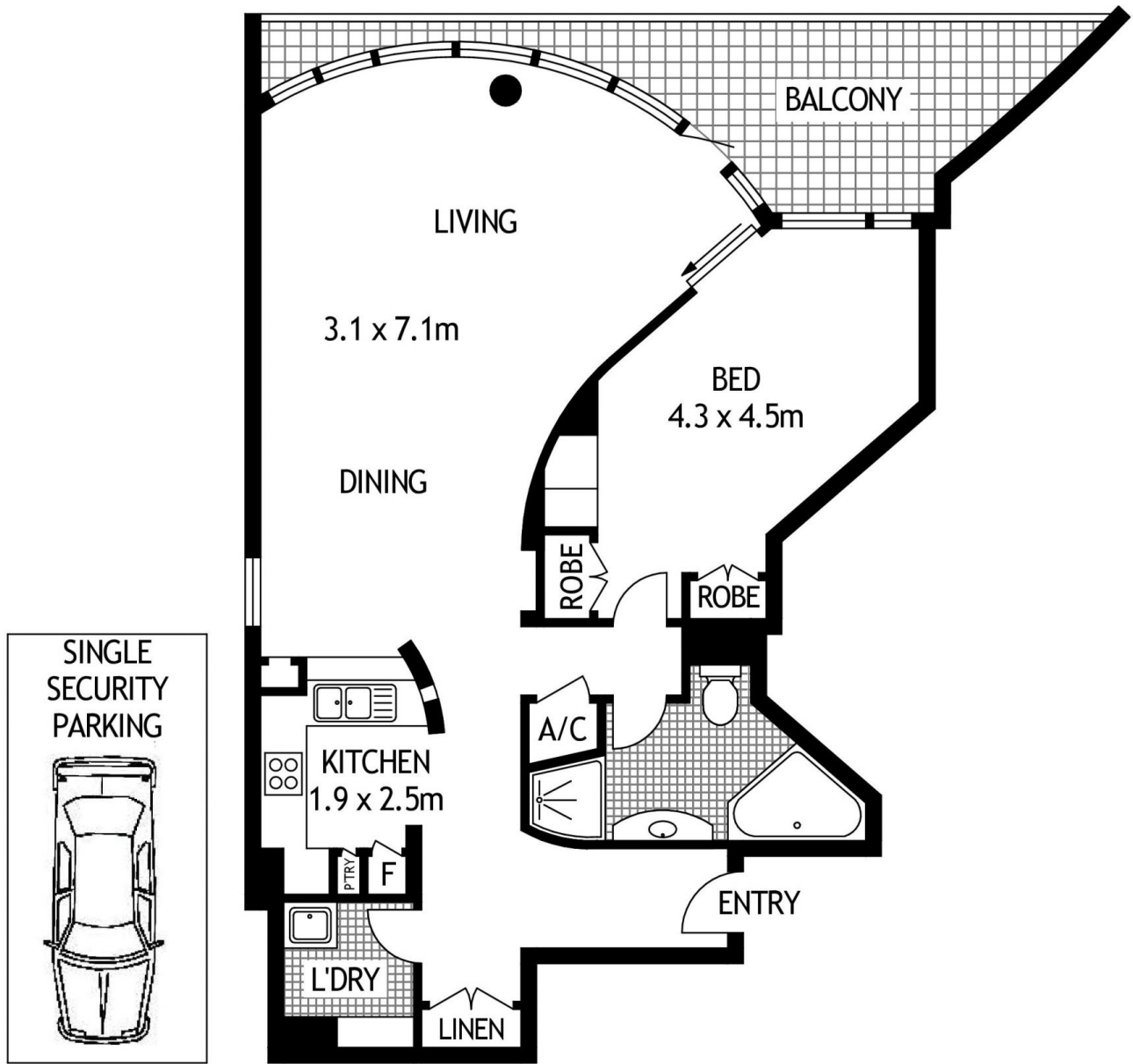

TENTH FLOOR



1008/61 MACQUARIE STREET

SYDNEY

SCAPE Floor Planning Disclaimer: This floor plan is conceptual only. It is provided for illustrative purposes only and should not be relied upon. We make no guarantee as to the correctness of this plan. All interested parties should make and rely on their own enquiries in determining the accuracy of the information contained in this floor plan.