

morton.

Zetland 207/28 Ebsworth Street

 1  1  1

Sold by Calvin Chan 0406 888 028

From its elevated position in Mirvac's iconic development, this sleek designer apartment captures a spectacular urban view. It provides a quiet retreat complemented by a location that's at the very heart of all the attractions that make Zetland such a fast-growing lifestyle destination.

- Bright interiors feature a generous open living and dining space
- A wide sheltered balcony that captures a sweeping panorama
- Double bedroom are fitted with built-in wardrobe
- A quality modern kitchen fitted with sleek gas appliances
- Ducted air conditioning, intercom and security lift access
- Walking distance to nearby Victoria Park and East Village

View



As advertised or by appointment

Agents

Calvin Chan

 0406 888 028
 calvin@morton.com.au

Ferenc Goemoeri

 0447 025 423
 ferenc.goemoeri@morton.com.au

morton.com.au

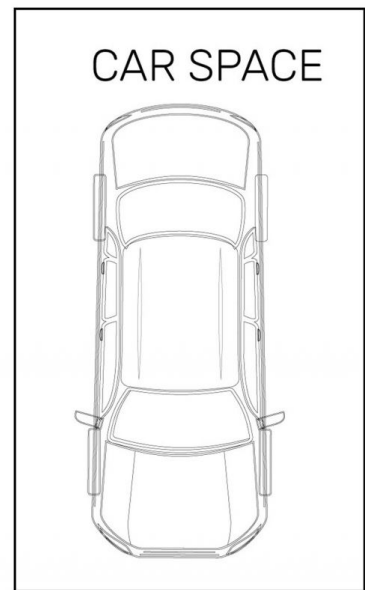
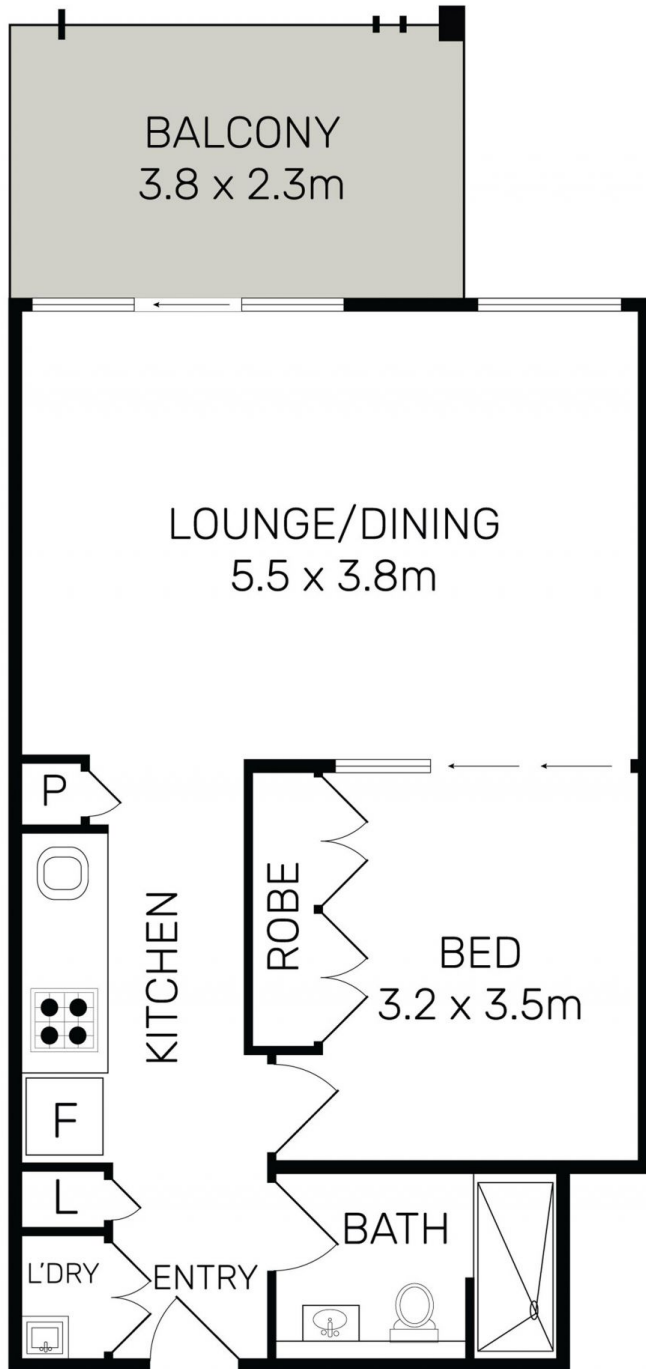

All information contained herein is gathered from all sources we believe to be reliable. However we cannot guarantee its accuracy and interested parties should rely on their own enquiries.



CampaignPROS

morton. Zetland 207/28 Ebsworth Street