



morton.

Waterloo 108/266 Pitt Street



This smart single bedroom property offers the right balance of bright interiors, leafy privacy and everyday convenience. Perfectly catering to professionals looking for a peaceful abode close to the city. It has all the essentials of easycare apartment living with good security, a low maintenance layout and a prime position in the 'Green Square Oasis' complex, directly opposite Waterloo Oval.

- A pleasant aspect overlooking the complex landscaped grounds
- Light and breezy open design that leads to a wide balcony
- Well-proportioned bedroom fitted with a large built-in robe and brand new chandelier
- Sleek modern kitchen fitted with gas fittings and dishwasher
- Designer bathroom plus a separate internal laundry
- Resort facilities include a swimming pool and gymnasium
- Brand new timber flooring in living area and bedroom
- Freshly painted and modern track lights installed
- Down the street from the popular cafe 'The Social Hideout'
- Plenty of on-street parking available in front of the building

View

As advertised or by appointment

Agent

Sarah Fowell

📞 0437 492 129

✉️ sarah@morton.com.au

morton.com.au

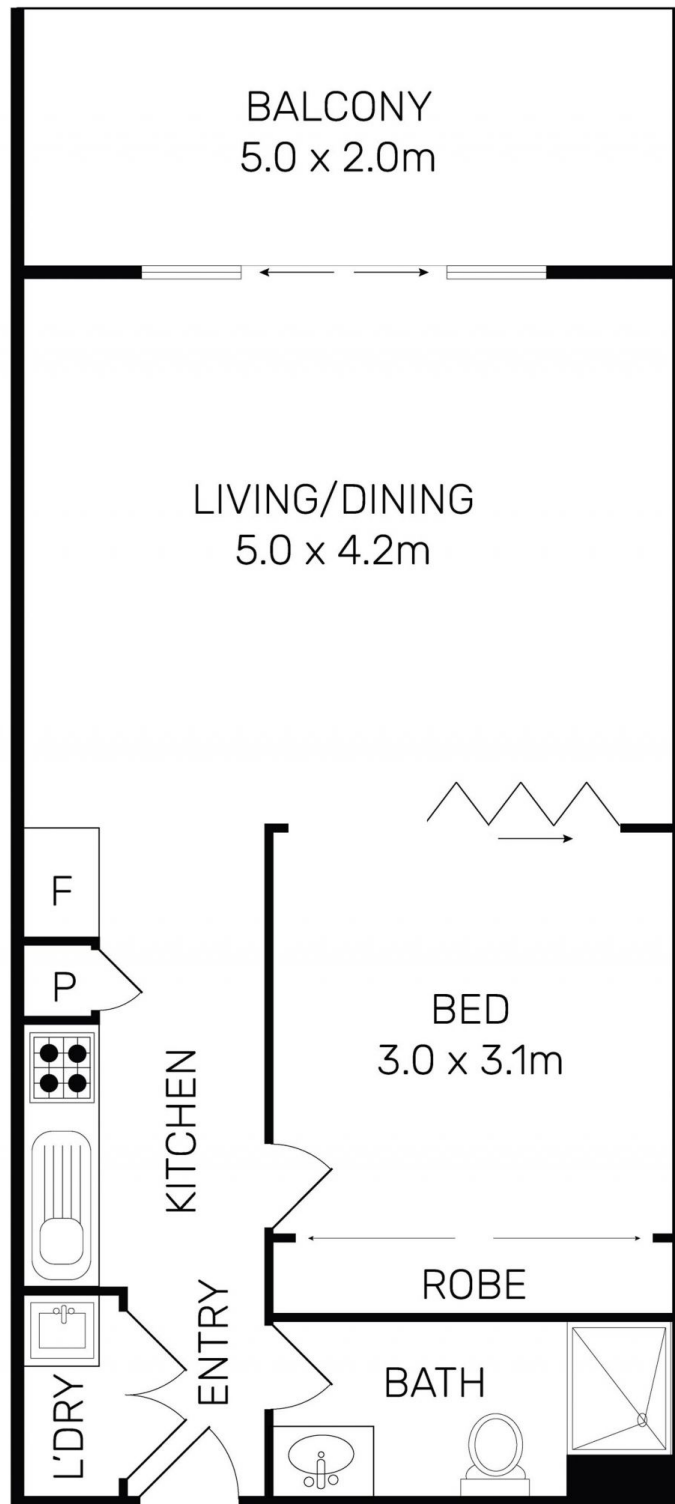

All information contained herein is gathered from all sources we believe to be reliable. However we cannot guarantee its accuracy and interested parties should rely on their own enquiries.



CampaignPROS

morton. Waterloo 108/266 Pitt Street