



# morton.

Penrith 701/91 Lord Sheffield Circuit

🛏 2 🚿 2 🚗 1

A boutique residence presenting a new standard of contemporary living in Penrith. Situated within the Thornton precinct and designed with luxury in mind, it promotes the best of urban living, surrounded by the space and calm of Sydney's greater west. Your expectations have changed. There's a desire for modern comfort, convenience and time to relax and enjoy the beauty that surrounds you. The Henry provides all that makes this possible - including an easy commute to work, amenities at your doorstep and the Nepean River or Blue Mountains a short drive away.

Inspired by nature's warm tones and textures, flowing soft lines and contrasting exterior finishes provide a sense of elegance and classic style. There's everything you need, with the little extras you'll love - including communal gardens, BBQ facilities and secure covered parking.

- Fresh and airy open design with timber flooring
- Good sized double bedroom with built-ins
- Covered balcony that captures elevated views to Ron Mulock

[morton.com.au](https://morton.com.au)

### View

As advertised or by appointment

### Agent

**David Lipman**

📞 0409 663 535

✉ [david@morton.com.au](mailto:david@morton.com.au)

# THE HENRY



APT 401  
501.601  
701.801

2 Bed | 2 Bath

Internal Area 77m<sup>2</sup>  
External Area 11m<sup>2</sup>  
Total Area 88m<sup>2</sup>

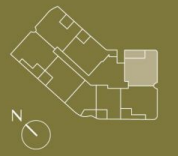

0m 1m 2m 3m

**URBAN**

Disclaimer: This floor plan has been prepared for marketing purposes only. All descriptions, dimensions, depictions and other details in this floor plan may not be to scale and may vary from the property as built. Your attention is drawn to the special conditions of the contract for sale of land. No third party has any authority to make or give any representations or warranties in relation to the property unless the representation or warranty is confirmed by the vendors and included in the contract for sale of land.

