



morton.

Wentworth Point 404/49 Hill Road

 1  1  1

Located in the vibrant Waterfront Estate, Quarterdeck by Billbergia is sophisticated urban living at its best. Quarterdeck is a waterfront development surrounding a beautifully landscaped garden, boasting ecologically sustainable design. The apartment features a versatile entertainer's winter garden overlooking parklands, solar tinted double glazed floor to ceiling glass, and air conditioning throughout living and bed quarters. Perfectly located just footsteps from Wentworth Point's Marina Square shopping precinct, Sydney Olympic Park ferry wharf, and public transport at your doorstep, this sleek abode offers the ideal home for the modern lifestyle.

Features:

- Superb natural light from its north-west aspect
- Timber flooring throughout open living and dining
- Winter garden spanning end to end with openable louvres for ventilation and versatile function
- Full kitchen with polished stone bench tops and premium appliances

morton.com.au

View

As advertised or by appointment

Agent

Sarah Fowell

 0437 492 129

 rentals@morton.com.au

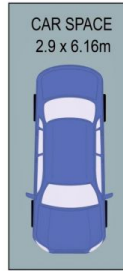
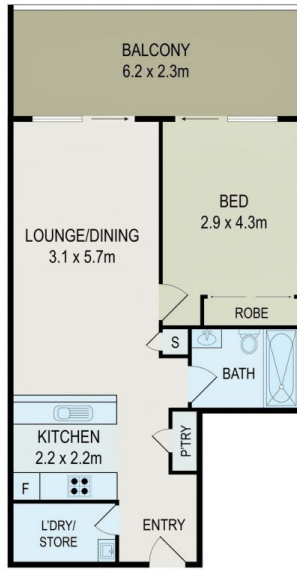

0 1 2 3 4 5

All information contained herein is gathered from all sources we believe to be reliable. However we cannot guarantee its accuracy and interested parties should rely on their own enquiries.



f CampaignPROS

404 / 49 Hill Road, Wentworth Point