

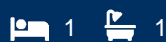

# morton.

Sydney 91 Liverpool Street



Located in the highly acclaimed 'World Tower' development is this immaculate apartment with the perfect qualities for even the most discerning tenant. Enjoy modern high-quality features as well as a private and light filled outlook onto the forecourt of World Square.

- Well-proportioned open plan lounge and dining
- Air conditioning, security access, built in laundry
- Full width entertainment balcony
- 24-hour onsite building management and security
- First class facilities including pool, spa, sauna, gym

This apartment offers the ultimate in inner city convenience, only a stone's throw from World Square, the newly completed CBD light rail and Central Station, creating a desirable home in an ideal city location.

With respect to the government's easing of restrictions around open homes but in a continuing effort to help stop the spread of COVID-19, we will conduct our scheduled open homes with

[morton.com.au](http://morton.com.au)

### View

As advertised or by appointment

### Agent

**Morton RE**



rentals@morton.com.au

# STUDIO UNIT

UNIT 1817, 1917, 2017  
 MIRROR UNIT 1808, 1908, 2008  
 AREA = 48.9m<sup>2</sup>  
 Level 18 - 20

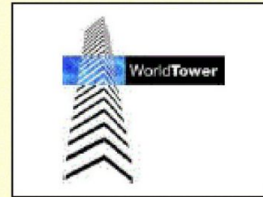
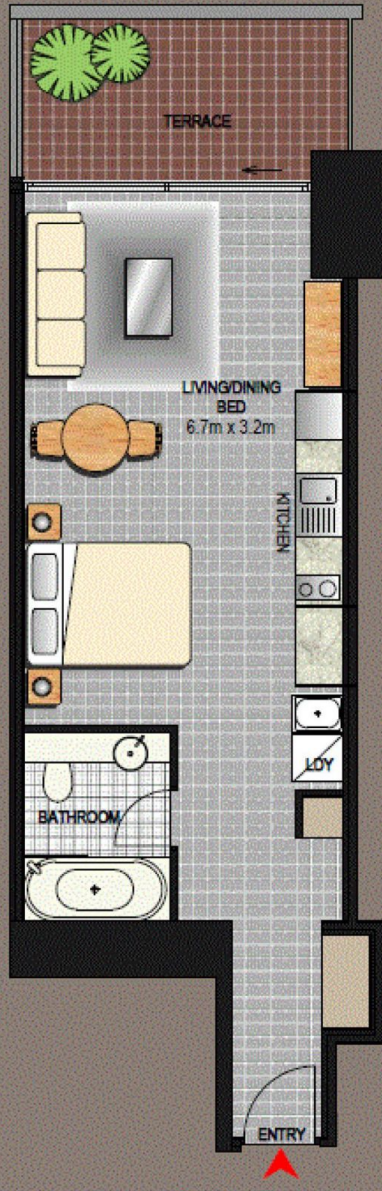

- Huge terrace
- Separate entry vestibule
- Fully tiled living areas

### PURCHASERS TAKE NOTE

These floorplans DO NOT FORM PART of the Contract for Sale of any lot within the development. They are INDICATIVE ONLY. The descriptions, layouts and areas set out in this floor plan are subject to change and may not accurately reflect the final design of each unit depicted.



METRO RISE

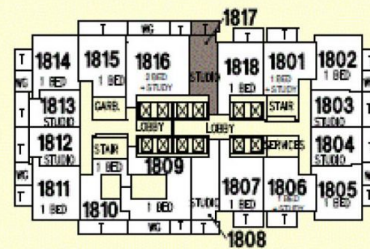

GEORGE STREET

05-2007