



morton.

Greenwich 10/214 Pacific Highway

 1  1  1

Offering the unique combination of a prized north-eastern aspect, a huge courtyard and designed with low maintenance luxury living in mind, this exceptional residence is an opportunity of undeniable quality. Impressively quiet and invitingly private, it has no common walls, boasts a substantial 139m² on title and is little more than a short stroll to St Leonards station and village conveniences.

- Vast sun-washed courtyard is ideal for entertaining
- Open plan lounge and dining area, bamboo floors
- Generous master with built-ins and courtyard access
- Chic kitchen, granite benches, Smeg gas appliances
- LUG with remote control and internal access in security basement
- Double glazing, AC and intercom security

View



As advertised or by appointment

Agents

Lucy White

 0413 930 760
 lucy@morton.com.au

Konstantin Melnikov

 0421 540 424
 konstantin@morton.com.au

morton.com.au

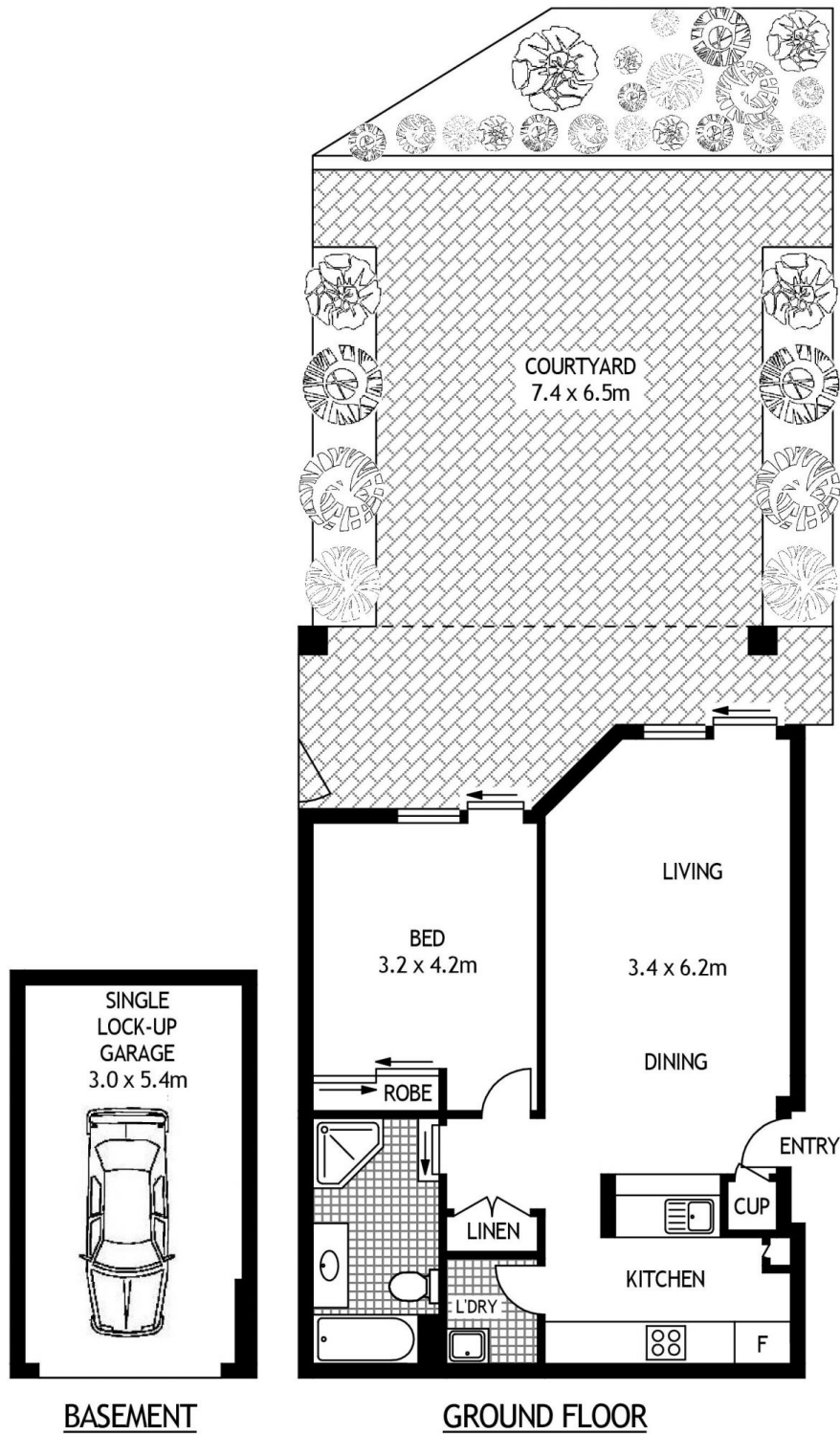

BASEMENT

GROUND FLOOR

10/214-220 PACIFIC HIGHWAY

GREENWICH

SCAPE Floor Planing Disclaimer: This floor plan is conceptual only. It is provided for illustrative purposes only and should not be relied upon. We make no guarantees to the correctness of this plan. All interested parties should make and rely on their own enquiries in determining the accuracy of the information contained in this floor plan.