



morton.

Wentworth Point 821/1B Burroway Road

2 2 1

Located in Jewel, this your opportunity to move into this luxury two bedroom waterfront residence offering lifestyle, comfort and convenience. Jewel is the iconic gateway that connects the Sydney Harbour to Wentworth Point, ideally positioned at the northern tip of the peninsular. Jewel is located adjacent to the Sydney Olympic Park ferry wharf and sits atop the Pierside retail precinct, with Wentworth Point's transport links and Marina Square shopping centre just footsteps away.

Features:

- Located on level 8 with westerly aspect
- Open living and dining areas leading directly to entertainer's balcony
- Hard flooring throughout living areas
- Large covered balcony overlooking the communal courtyard
- Fully equipped gas kitchen with premium appliances, stone bench tops, and soft closing cupboards
- Spacious bedrooms with built wardrobes
- Split system reverse cycle air conditioning

morton.com.au

View

As advertised or by appointment

Agent

Sarah Fowell

0437 492 129

rentals@morton.com.au

GOLD SCREEN FACADE



APARTMENT

821

LOT 141
2BED + STUDY

Internal	79 sqm
External	13 sqm
Total	92 sqm

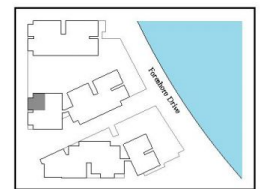

LEVEL 8



7
N

Disclaimer: This floor plan has been prepared for marketing purposes only. All descriptions, dimensions, depictions and other details in this floor plan may not be to scale and may vary from the property as built. Your attention is drawn to the special conditions of the contract for sale of land. No third party has any authority to make or give any representation or warranty in relation to the property unless the representation or warranty is confirmed by Paces Communities Werriworth Pty Ltd, 661 FWT Development Pty Ltd and included in the contract for sale of land. 5/2018 Disclaimer: In this disclaimer, Developer means Pace Communities Werriworth Pty Ltd ACN 168 420 746 and 661 FWT Development Pty Ltd ACN 164 28 145. Development means the retail and residential development at Burnside Road Werriworth Town Centre at Level 5/2018 means Sydney Olympic Park Authority, a statutory body constituted under the Sydney Olympic Park Authority Act 2002 (NSW). The Developer is responsible for all matters in connection with understanding and completing all of the works required to be performed or carried out to complete the Development and 5/2018 has no responsibility or involvement in those matters. (Rev C_01/06/15)