



morton.

North Sydney 204/1A Eden Street



Set in a superb peaceful location convenient to both local/CBD transport and a cosmopolitan lifestyle where you are moments walk away from cafes, restaurants and only a short drive to the CBD.

- Near new quality fixtures and finishes
- Sizeable balcony with leafy outlook
- East facing position, natural light throughout
- Spacious open plan living, with timber floors
- Gourmet kitchen, Smeg appliances
- Master bedroom with built in wardrobes and new plantation shutters
- Internal laundry, with combo washer/dryer
- Air conditioning and ceiling fans
- Storage cage
- Secure building, intercom and lift access

View

As advertised or by appointment

Agent

Morton



info@morton.com.au

morton.com.au

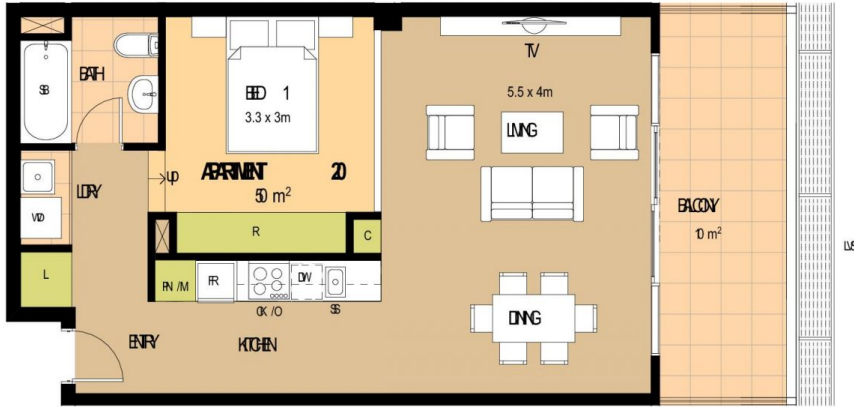

TOTAL AREA 60 m²

MDG
MORE DISCOUNT GROUP

RIGEL

1A BEN SHEET , NPH , SNEY , NSV , ZIB

APARTMENT 20

SFRA UNIT 20
USE TYPE 1 BEDROOM
AREAS 1 BEDROOM
FRING NOE
INTERNAL FLOOR 50 m²
SCOURE 10 m²

TOTAL AREA 60 m²

- KEY :
- L - LINEN
 - LDV - LAUNDRY
 - VD - WARDER / DRESS
 - SB - SHOWER / SHOWER OVER
 - SR - SHOWER
 - C - CLOSET
 - R - REFR
 - FR - FRIDGE
 - SS - SINK
 - DW - DRAINAGE
 - OK/O - OVEN / COOK TOP / GRILL
 - FR / M - FRYING / MICROWAVE
 - US - LOUVER

- COLOR KEY
- GREEN - GREEN
 - ORANGE - TERRAZZO SIDE
 - BROWN - SILENT / SPOT / OLD FLOOR
 - YELLOW - SCOURE

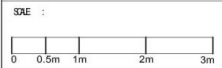

DISCLAIMER: THE INFORMATION IS NOT TO BE USED AS A BASIS FOR THE DESIGN OF BUILDING STRUCTURES AND TO NOT CONSTITUTE AN OFFER OF CONTRACT OR ANY OTHER LEGAL DOCUMENT. THE USER OF THIS PLAN IS RESPONSIBLE FOR THE DESIGN AND CONSTRUCTION OF THE BUILDING. THE INFORMATION IS NOT TO BE USED FOR ANY OTHER PURPOSES. THE USER OF THIS PLAN IS RESPONSIBLE FOR THE DESIGN AND CONSTRUCTION OF THE BUILDING. THE INFORMATION IS NOT TO BE USED FOR ANY OTHER PURPOSES. THE USER OF THIS PLAN IS RESPONSIBLE FOR THE DESIGN AND CONSTRUCTION OF THE BUILDING.