



# morton.

**Wentworth Point** 446/2 The Crescent

 2  2  2

Located in Lipari by The Promenade, this is your opportunity to move into this spacious two bedroom plus study apartment with uninterrupted water view, and a true north facing balcony accessible from all bed and living rooms. Only a short stroll to The Piazza and Wentworth Point's exclusive Pulse Club providing gymnasium, swimming pool and tennis court facilities all year round. Situated in The Waterfront estate, you'll be moments from Marina Square shopping centre, ferry and bus links to the city and Parramatta, Sydney Olympic Park main venues and train station, Bicentennial Park and Millennium Parklands.

#### Features:

- North facing entertainer's balcony
- Spacious living and dining rooms
- Fully equipped kitchen with premium stainless steel appliances
- Gas cooking and lots of cupboard space
- Generous bedrooms with built-in wardrobes

[morton.com.au](http://morton.com.au)

#### View

As advertised or by appointment

#### Agent

**Sarah Fowell**

 0437 492 129

 [rentals@morton.com.au](mailto:rentals@morton.com.au)

ENTRY	01
LIVING	02
DINING	03
KITCHEN	04
BEDROOM 1	05
BEDROOM 2	06
STUDY	08
BATHROOM	09
ENSUITE	10
LAUNDRY	11
BALCONY	12
STORAGE	14
CLOTHES DRYING	15

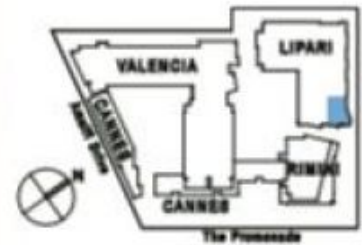

*Lipari*

Unit 446

Lot Number 105  
 Type 2 Bedroom  
 Unit Area 98m<sup>2</sup>  
 Balcony 28m<sup>2</sup>  
 Total 126m<sup>2</sup>  
 Scale 1:100



Disclaimer: All Layouts are Indicative only, and subject to change.

0 2.5 5M