

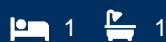

morton.

Sydney 1917/91 Liverpool Street



Located in the highly acclaimed 'World Tower' development is this immaculate apartment with the perfect qualities for even the most discerning tenant. Recently updated throughout, enjoy modern high-quality features as well as a private and light filled East facing outlook onto the forecourt of World Square.

- Well-proportioned open plan lounge and dining
- Air conditioning, security access, built in laundry
- Full width entertainment balcony, additional storage cage
- 24-hour onsite building management and security
- First class facilities including pool, spa, sauna, gym, onsite childcare and more

This apartment offers the ultimate in inner city convenience, only a stone's throw from World Square, the newly completed CBD light rail and Central Station, creating a desirable home in an ideal city location.

With respect to the government's easing of restrictions around

morton.com.au

View

As advertised or by appointment

Agent

Morton RE



rentals@morton.com.au

STUDIO UNIT

UNIT 1817, 1917, 2017
 MIRROR UNIT 1808, 1908, 2008
 AREA = 48.9m²
 Level 18 - 20

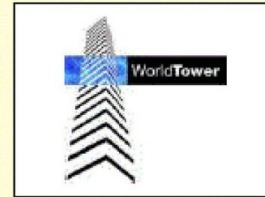
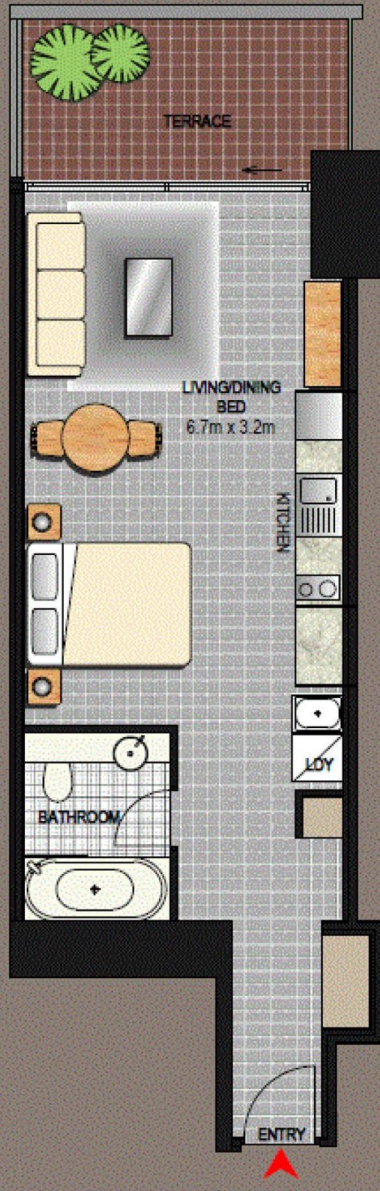

- Huge terrace
- Separate entry vestibule
- Fully tiled living areas

PURCHASERS TAKE NOTE

These floorplans DO NOT FORM PART of the Contract for Sale of any lot within the development. They are INDICATIVE ONLY. The descriptions, layouts and areas set out in this floor plan are subject to change and may not accurately reflect the final design of each unit depicted.



METRO RISE

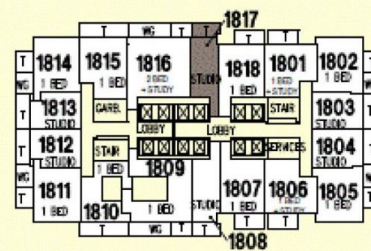

GEORGE STREET

05-2007