



**morton.**

**Riverwood** 423/1 Vermont Crescent

 2  2  1

Fresh, bright and displaying a smart contemporary style, this ultra-modern security apartment captures the essence of low maintenance living with designer finishes, generous proportions and a great lifestyle location. It offers easy access to Hurstville CBD, with a range of shopping, cafe and transport amenities all within a stroll from the front door.

- Generous single level layout with a light and airy open design
- Two entertainment balconies with elevated leafy outlooks
- Two double bedrooms with built-ins plus a separate study area
- Designer kitchen equipped with premium European appliances
- Security basement car space and a storage cage
- Air conditioning, lift access and intercom entrance
- Two designer bathrooms include one with a full bathtub
- Landscaped surrounds with shared gardens, entertainment areas

**View**

As advertised or by appointment

**Agent**

**Lisa Xi**

 0401 311 667

 lisa@morton.com.au

**morton.com.au**

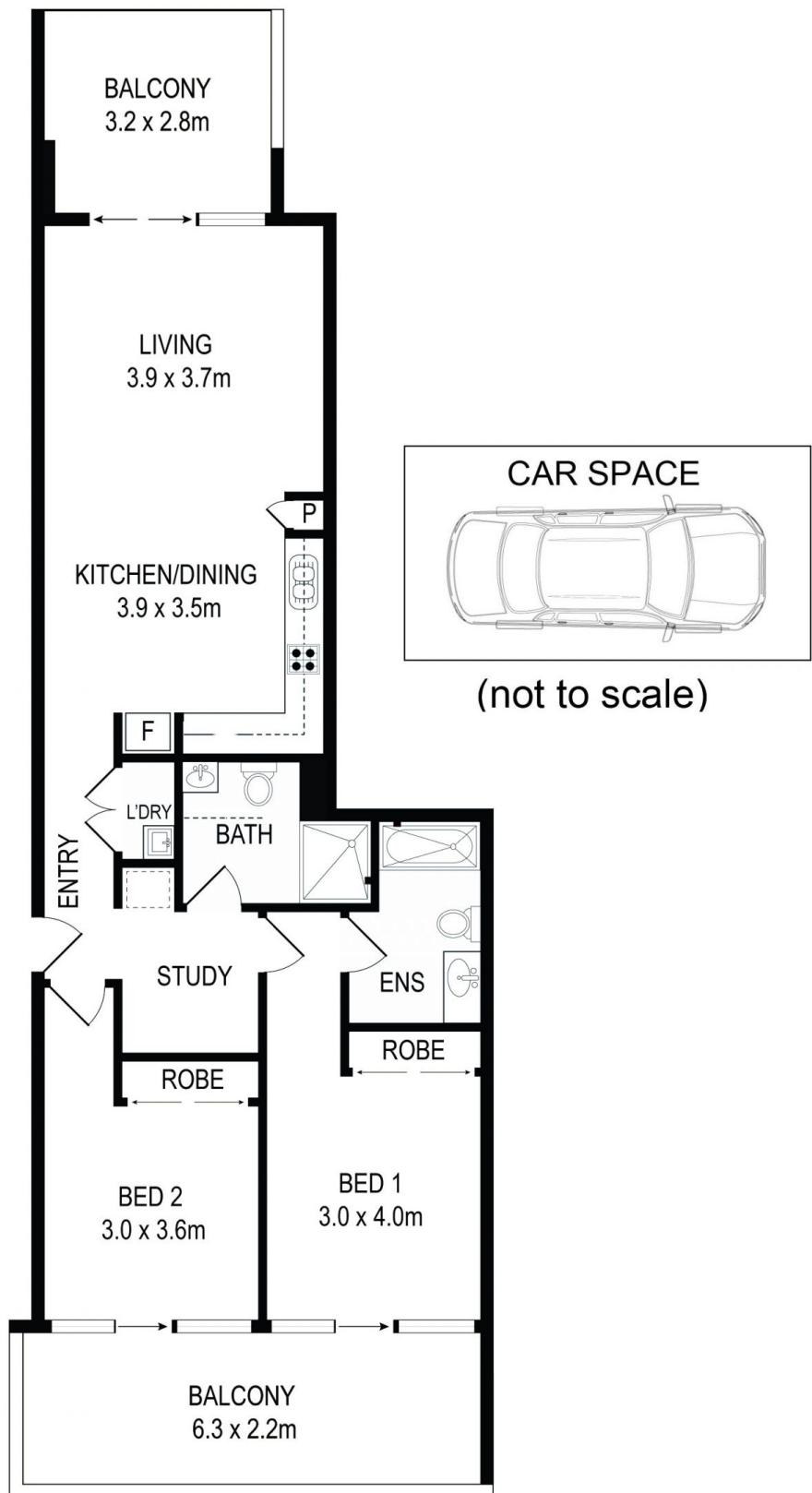

All information contained herein is gathered from all sources we believe to be reliable. However we cannot guarantee its accuracy and interested parties should rely on their own enquiries.



CampaignPROS

morton.

Riverwood 423/1 Vermont Cres