



# morton.

**Wentworth Point** 285/33 Hill Road

 2  2  1

The Waterfront is located moments to Sydney Olympic Park main venues, train station, Bicentennial Park and Millennium Parklands. Located in Palermo, this is your opportunity to move into this two bedroom apartment only a short stroll from The Promenade and The Piazza.

- Combined living and dining rooms
- Split system air conditioning in open living area
- Full kitchen with stainless steel appliances
- Large Balcony
- Gas cooking and quality finishes throughout
- Main bedroom with ensuite
- Bedrooms with built in wardrobes
- Study nook
- Laundry room and clothes dryer
- Single car space + storage cage

### View

As advertised or by appointment

### Agent

**Morton RE**

 [rentals@morton.com.au](tel:)

[morton.com.au](http://morton.com.au)



- ENTRY 1
- LIVING 2
- DINING 3
- KITCHEN 4
- MAIN BEDROOM 5
- BEDROOM 2 6
- ENSUITE 7
- BATHROOM 8
- LAUNDRY 9
- LINEN 10
- BALCONY 11
- CLOTHES DRYING 12

LEVEL 02

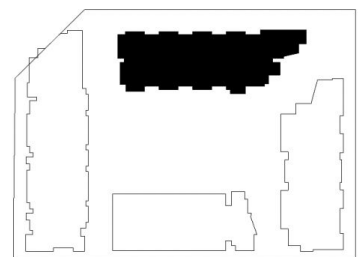

# PALERMO

UNIT: **285**

TYPE: 2 Bedroom

UNIT AREA: 91.0 sqm

OUTDOOR AREA: 26.0 sqm



Disclaimer: All layouts are indicative only, and subject to change.



0 2.5 5M