



# morton.

**Ermington** 642/64 River Road

 2  2  1

Located in the new urban hub of Ermington, here is your opportunity to move into this fabulous near new apartment. Located within close proximity to river, cycle way and parks.

#### APARTMENT FEATURES

- Good size 2 bedrooms, main with en-suite
- Built in wardrobes
- Internal laundry + dryer
- Reverse cycle air conditioning in living room
- Stainless steel kitchen appliances
- Dishwasher, microwave + gas cooking
- Data/TV points in living and main bedroom
- Mirrored cabinets in bathroom
- Security building with video intercom
- Single car space and storage cage

#### NEIGHBORHOOD FACILITIES

- Woolworths, Liquorland, Bakery 900m away
- Local bus routes (523, 524, 525 600m-1.5km away)
- West Ryde Railway station 4.2kms away

#### View

As advertised or by appointment

#### Agent

**Morton RE**



 [rentals@morton.com.au](mailto:rentals@morton.com.au)

[morton.com.au](http://morton.com.au)



**SIRIUS**  
**APARTMENT 642**  
**LOT 293**

2 BEDROOM

Internal	81 sqm
External	9 sqm
<b>Total</b>	<b>90 sqm</b>

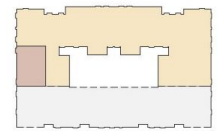

SIRIUS - LEVEL 6

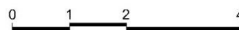

Disclaimer: This floor plan has been prepared for marketing purposes only. All descriptions, dimensions, depictions and other details in this floor plan may not be to scale and may vary from the property as built. Your attention is drawn to the special conditions of the contract for sale of land. No third party has any authority to make or give any representation or warranty in relation to the property unless the representation or warranty is confirmed by the vendors and included in the contract for sale of land. Date Issued: 03/10/14 Revision: A