



# morton.

**Wentworth Point** 413/18 Corniche Drive

 2  2  1

Super spacious, sunny and bright large 2 bedroom apartment.

Located on level 4, corner position with great views onto outdoor lagoon pool.

- Large, well designed floor plan
- Double size bedrooms
- Built-in wardrobes
- En-suite to main bathroom
- Full size kitchen with plenty of pantry space
- Spacious living area flowing onto balcony
- Fully covered wrap balcony
- Sunny aspect with plenty of natural light to all rooms in the apartment
- Air conditioning
- Internal laundry + dryer
- Study nook area
- Very well kept home unit
- Storage Cage

Also you have access to become a member of the Pulse,

[morton.com.au](https://www.morton.com.au)

### View

As advertised or by appointment

### Agent

**Morton RE**



 [rentals@morton.com.au](mailto:rentals@morton.com.au)

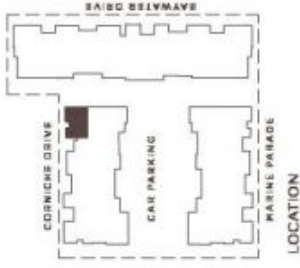

LOCATION

## UNIT 413 2 BEDROOM

INTERNAL 91 sqm  
BALCONY 28 sqm  
TOTAL AREA 119 sqm

KEY:

- 1 Entry
- 2 Living
- 3 Dining
- 4 Kitchen
- 5 Bedroom 1
- 6 Bedroom 2
- 7 Wardrobe
- 8 Study
- 9 Bathroom
- 10 Ensuite
- 11 Laundry
- 12 Store
- 13 Balcony



REV. D



Disclaimer: The purchaser should use this plan as a guide only for the purposes of identifying parameters and do not constitute an offer or contract. All descriptions, dimensions, references to architects and necessary parameters for use and other details are given in good faith and are believed to be correct, but any intending purchaser should verify all details in documents or representations of fact, fact and liability shall remain the responsibility of the purchaser or the relevant authority. No liability is accepted for any errors or omissions. External areas may be subject to development opportunities, subject to the local council approval.

**CATANIA**  
THE WATERFRONT



**THE WATERFRONT**  
WENTWORTH POINT