



morton.

Wentworth Point 301/16 Corniche Drive

 2  2  2

The Waterfront is located moments to Sydney Olympic Park main venues, train station, Bicentennial Park and Millennium Parklands. Located in Catania, this is your opportunity to move into this two bedroom apartment only a short stroll from The Promenade and The Piazza.

- Luxury waterfront apartment located on level seven
- Combined living and dining rooms
- Air conditioning
- Full size kitchen with designer modern stainless steel appliances
- Gas cooking and quality finishes throughout
- Generous size separate living areas
- Good size bedrooms with built-in wardrobes
- Laundry room and clothes dryer
- Two car spaces and storage cage.

View

As advertised or by appointment

Agent

Morton RE



 rentals@morton.com.au

morton.com.au

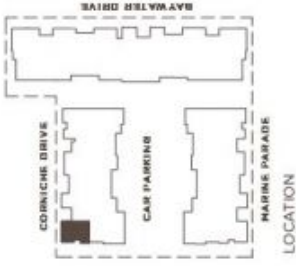

LOCATION

UNIT 301 2 BEDROOM

INTERNAL 90 sqm
BALCONY 16 sqm
TOTAL AREA 106 sqm

KEY:

- 1 Entry
- 2 Living
- 3 Dining
- 4 Kitchen
- 5 Bedroom 1
- 6 Bedroom 2
- 7 Wardrobe
- 8 Bathroom
- 9 Ensuite
- 10 Laundry
- 11 Store
- 12 Balcony

REV. D



Builder: The particulars are not to be construed as a contract. All dimensions, descriptions, references to conditions and technical specifications for work and other details are given in good faith and are believed to be correct. We are providing this information to you for your information only. It is not intended to constitute an offer of any financial product or service. We do not warrant the accuracy or completeness of the information provided. It is not intended to constitute an offer of any financial product or service. It is not intended to constitute an offer of any financial product or service. It is not intended to constitute an offer of any financial product or service.