



morton.

Wentworth Point 43/27 Bennelong Parkway

 1  1  1

The Waterfront is located moments to Sydney Olympic Park main venues, train station, Bicentennial Park and Millennium Parklands. Located in Mariners' Cove, this is your opportunity to move into this one bedroom apartment only a short stroll from The Promenade and The Piazza.

- Open kitchen with plenty of cupboard space
- Stainless steel appliances and gas cooking
- Loads of natural light flowing into the living area
- Good size bedroom with built-in wardrobe
- Laundry room with clothes dryer
- Balconies allowing natural ventilation overlooking the archery centre
- Split system air conditioning
- Single car space

View

As advertised or by appointment

Agent

Morton RE



 rentals@morton.com.au

morton.com.au

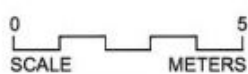

DISCLAIMER
 NO RESPONSIBILITY TAKEN FOR INFORMATION PROVIDED HEREIN.
 INTERESTED PARTIES SHOULD RELY ON THEIR OWN ENQUIRIES
 AND THE CONTRACT FOR SALE. CARPARK AREAS NOT INCLUDED,
 REFER TO STRATA PLANS FOR ADDITIONAL INFORMATION.

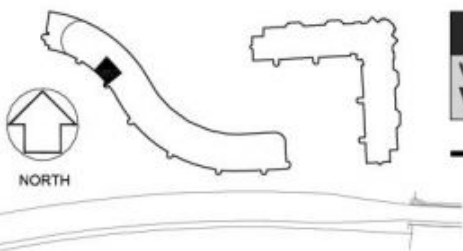

APARTMENT 43
 1 BEDROOM

INTERNAL AREA 44 sqm
 EXTERNAL AREA 9 sqm
 TOTAL AREA 53 sqm

MARINERS COVE

RESIDENTIAL APARTMENTS
 27 Bennelong Road
 Homebush Bay