



morton.

Wentworth Point 302/4 Nuvolari Place

 1  1  1

With a north facing aspect and courtyard access to well manicured gardens, this one bedroom apartment in Palermo offers space in a private environment. Features include:

- Combined living and dining rooms
- Full size kitchen with stainless steel appliances
- Split system air conditioning
- Great size bedroom with huge built-in wardrobes
- Bedroom with en-suite
- Laundry room and clothes dryer
- Secure undercover car space and a storage cage
- Palermo building includes exclusive gym and pool
- The apartment is NBN enabled
- Pet friendly

View

As advertised or by appointment

Agent

Morton RE



 rentals@morton.com.au

morton.com.au

- ENTRY 1
- LIVING 2
- DINING 3
- KITCHEN 4
- BEDROOM 5
- ENSUITE 6
- LAUNDRY 7
- LINEN 8
- BALCONY 9
- CLOTHES DRYING 10



LEVEL 03

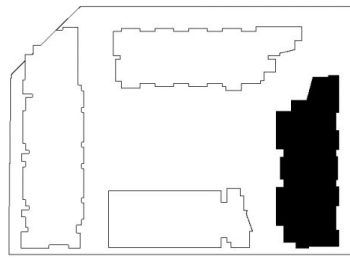

PALERMO

UNIT: **302**

TYPE: 1 Bedroom

UNIT AREA: 54.0 sqm

OUTDOOR AREA: 29.0 sqm



Disclaimer: All layouts are indicative only, and subject to change.

