



morton.

Wentworth Point 335/23 Savona Drive

 1  1  1

The Waterfront is located moments to Sydney Olympic Park main venues, train station, Bicentennial Park and Millennium Parklands. Located in Palermo, this is your opportunity to move into this one bedroom and study apartment only a short stroll from The Promenade and The Piazza.

- Located on level three with courtyard
- Combined living and dining room
- Reverse cycle air conditioning
- Full size kitchen with stainless steel appliances
- Gas cooking and lots of cupboard space
- Great size bedroom with huge built-in wardrobes
- Laundry room and clothes dryer and washing machine
- Secure undercover car space and storage cage
- Palermo building includes exclusive pool and gym

Pulse Club membership is also available, giving you access to the local gym, in-door lap pool, outdoor lagoon pool, steam room and two tennis courts. Close to restaurants, local shops, public transport and ferry service to Parramatta and CBD.

View

As advertised or by appointment

Agent

Morton RE



 rentals@morton.com.au

morton.com.au



ENTRY	1
LIVING	2
DINING	3
KITCHEN	4
MAIN BEDROOM	5
BATHROOM	6
LAUNDRY	7
LINEN	8
BALCONY	9
CLOTHES DRYING	10
STUDY	11

LEVEL 03

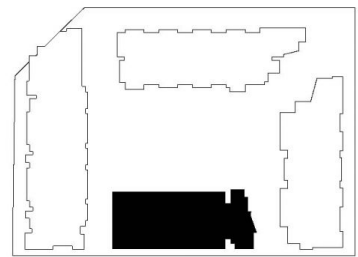

PALERMO

UNIT: **335**

TYPE: 1 Bedroom+Study

UNIT AREA: 59.0 sqm

OUTDOOR AREA: 36.0 sqm



Disclaimer: All layouts are indicative only, and subject to change.

ALLEN JACK+COTTIER



0 2.5 5M