



morton.

Wentworth Point 632/26 Baywater Drive

 2  2  2

The Waterfront is located moments to Sydney Olympic Park main venues, train station, Bicentennial Park and Millennium Parklands. Located in Catania, this is your opportunity to move into this two bedroom apartment only a short stroll from The Promenade and The Piazza.

- Located on level six with water views
- Combined living and dining room
- Reverse cycle air conditioning
- Full size kitchen with stainless steel appliances
- Gas cooking and lots of cupboard space
- Great size bedroom with huge built-in wardrobes
- Laundry room with clothes dryer
- Secure undercover double car space and storage cage

Pulse Club membership is also available, giving you access to the local gym, in-door lap pool, outdoor lagoon pool, steam room and two tennis courts. Close to restaurants, local shops, public transport and ferry service to Parramatta and CBD.

View

As advertised or by appointment

Agent

Sarah Fowell

 0437 492 129

 rentals@morton.com.au

morton.com.au

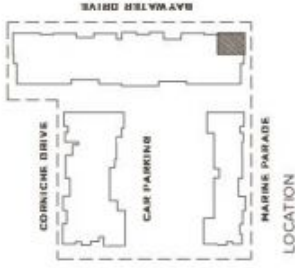

LOCATION

UNIT 632 2 BEDROOM

INTERNAL 90 sqm
BALCONY 22 sqm
TOTAL AREA 112 sqm

KEY:

- 1 Entry
- 2 Living
- 3 Dining
- 4 Kitchen
- 5 Bedroom 1
- 6 Bedroom 2
- 7 Wardrobe
- 8 Study
- 9 Bathroom
- 10 Ensuite
- 11 WC
- 12 Laundry
- 13 Store
- 14 Balcony/Courtyard

REV. A



Builder: The particulars are not to be construed as a contract. All dimensions, descriptions, references to conditions and technical specifications for work and other details are given in good faith and are believed to be correct. We are providing this information to you for your information only. It is not intended to constitute an offer or a contract. We must satisfy the relevant requirements of other relevant laws, and where necessary seek advice. No third party together with their agents has any authority to make or give any representation or warranty in relation to this property.
*Dimensions may be larger for display purposes. Refer to the detailed area schedule.