



morton.

Wentworth Point 115/27 Bennelong Parkway

 2  1  1

The Waterfront is located moments to Sydney Olympic Park main venues, train station, Bicentennial Park and Millennium Parklands. Located in Mariners Cove, this is your opportunity to move into this two bedroom apartment only a short stroll from The Promenade and The Piazza.

- Combined living and dining room
- Open kitchen with stainless steel appliances
- Gas cooking and lots of cupboard space
- Great size bedrooms with built-in wardrobes
- Laundry room and clothes dryer
- Secure undercover car space
- Mariners' Cove building includes exclusive pool and gym

Mariners' Cove Residents gives you access to the local gym, outdoor lagoon pool, outdoor heated swimming pool and steam room. Close to restaurants, local shops, public transport and ferry service to Parramatta and CBD.

View

As advertised or by appointment

Agent

Morton RE

 [rentals@morton.com.au](tel:)

morton.com.au



DISCLAIMER
 NO RESPONSIBILITY TAKEN FOR INFORMATION PROVIDED HEREIN.
 INTERESTED PARTIES SHOULD RELY ON THEIR OWN ENQUIRIES
 AND THE CONTRACT FOR SALE. CARPARK AREAS NOT INCLUDED,
 REFER TO STRATA PLANS FOR ADDITIONAL INFORMATION.

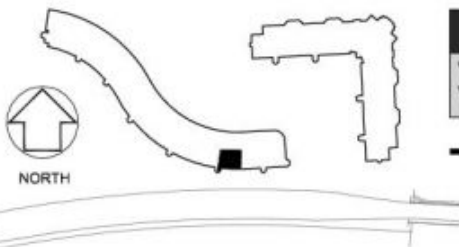

APARTMENT 115

2 BEDROOM

INTERNAL AREA 61 sqm
 EXTERNAL AREA 17 sqm
 TOTAL AREA 78 sqm

MARINERS COVE

RESIDENTIAL APARTMENTS

27 Bennelong Road
 Homebush Bay