



**morton.**

**Wentworth Point** 710/6 Nuvolari Place

 1  1  1

The Waterfront is located moments to Sydney Olympic Park main venues, train station, Bicentennial Park and Millennium Parklands. Located in Palermo, this is your opportunity to move into this one bedroom apartment only a short stroll from The Promenade and The Piazza.

- Located on level seven facing the Palermo Courtyard
- Combined living and dining room
- Reverse cycle air conditioning
- Full size kitchen with stainless steel appliances
- Gas cooking and lots of cupboard space
- Great size bedroom with huge built-in wardrobe
- Laundry room and clothes dryer
- Secure undercover car space and a storage cage
- Palermo building includes exclusive gym and pool

Pulse Club membership is also available, giving you access to the local gym, in-door lap pool, outdoor lagoon pool, steam room and two tennis courts. Close to restaurants, local shops, public transport and ferry service to Parramatta and CBD.

**View**

As advertised or by appointment

**Agent**

**Morton RE**



 rentals@morton.com.au

**morton.com.au**

- ENTRY 1
- LIVING 2
- DINING 3
- KITCHEN 4
- BEDROOM 5
- BATHROOM 6
- LAUNDRY 7
- LINEN 8
- TERRACE 9
- CLOTHES DRYING 10



LEVEL 07

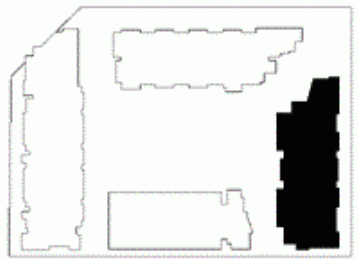

# PALERMO

UNIT: **710**

TYPE: 1 Bedroom

UNIT AREA: 65.0 sqm

OUTDOOR AREA: 11.0 sqm



Disclaimer: All layouts are indicative only, and subject to change.

