



morton.

Sydney 403/45 Shelley Street



Situated on the 4th floor at King Street Wharf this unique fully furnished 66sqm apartment features a large open plan living area with separate bedroom. Both living and bedroom lead out onto an expansive balcony which spans the entire length of the apartment. Quiet location with pleasant leafy outlook and Harbour glimpses.

- Generous bedroom with built-in wardrobes
- Entertainers' balcony
- Separate study
- Stylish open plan kitchen with island bench and gas stove
- Luxurious mosaic bathroom and internal laundry
- Intercom system
- Reverse cycle air conditioning

View

As advertised or by appointment

Agent

Morton RE



rentals@morton.com.au

morton.com.au

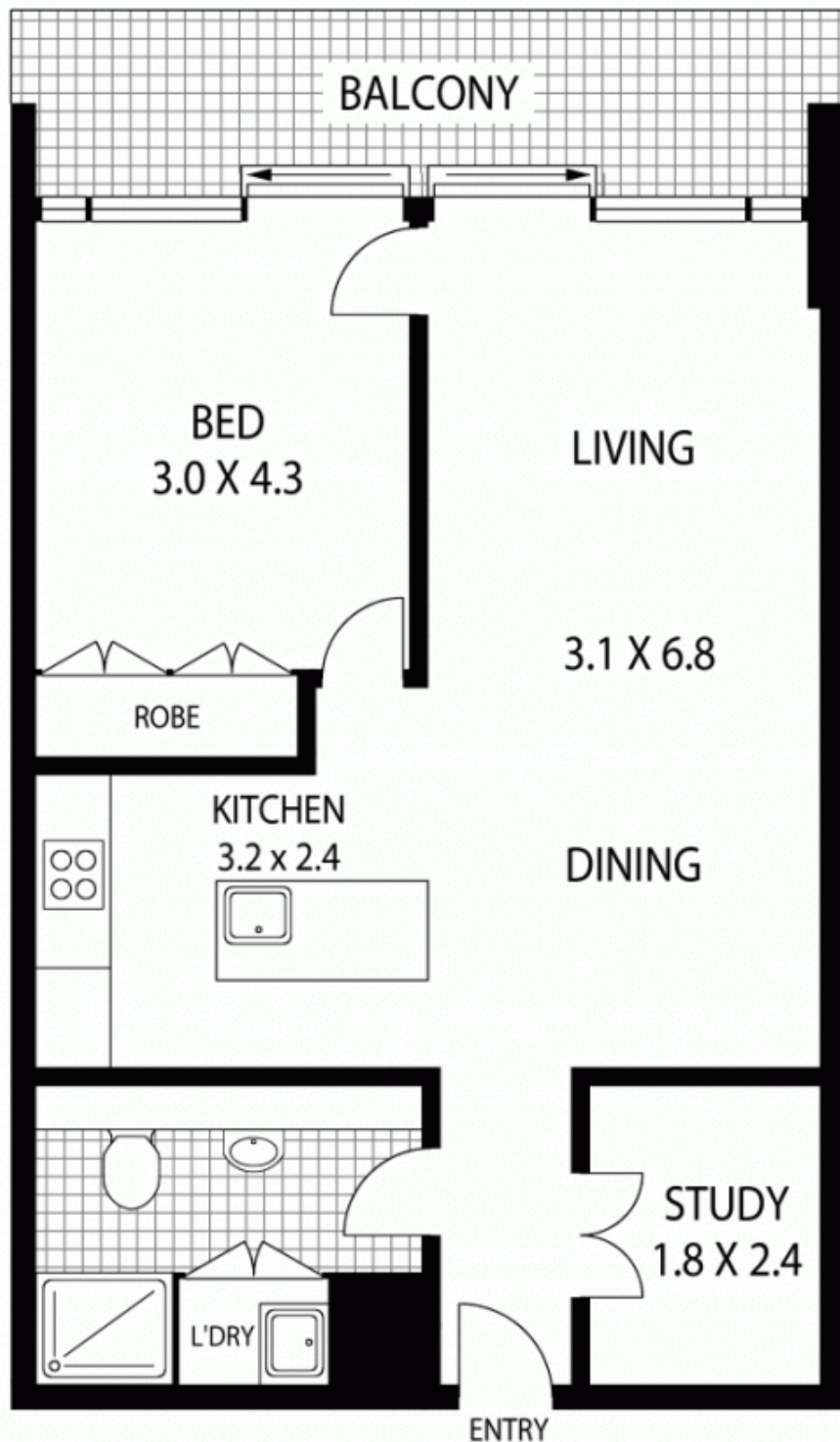

FOURTH FLOOR



403/45 SHELLEY STREET

SYDNEY

NOTE : SINGLE SECURITY
PARKING ON TITLE

SCAPE Floor Planning Disclaimer: This floor plan is conceptual only. It is provided for illustrative purposes only and should not be relied upon. We make no guarantee as to the correctness of this plan. All interested parties should make and rely on their own enquiries in determining the accuracy of the information contained in this floor plan.