



**morton.**

**Sydney** 217/45-49 Shelley Street



Located in chic King Street Wharf precinct this apartment is ideal for the professional on the run wanting to reside or invest in an urban location. Consisting of a very desirable floor plan with quality finishes and ample space, this property has an air of modernity and style.

- Bedroom with built-in cupboards
- Separate study area
- Open plan living/ dining area
- Modern kitchen
- Dishwasher
- Bathroom and internal laundry (Washing machine/dryer)
- Air conditioning, security building

**View**

As advertised or by appointment

**Agent**

**Morton RE**



rentals@morton.com.au

**morton.com.au**

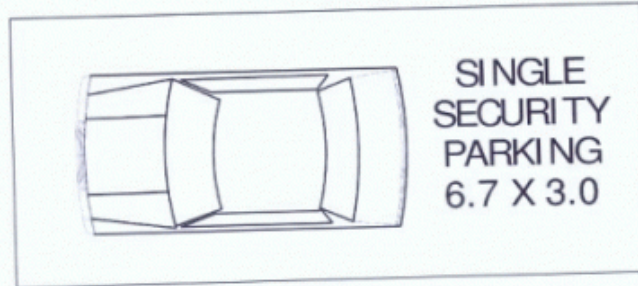

BASEMENT FLOOR

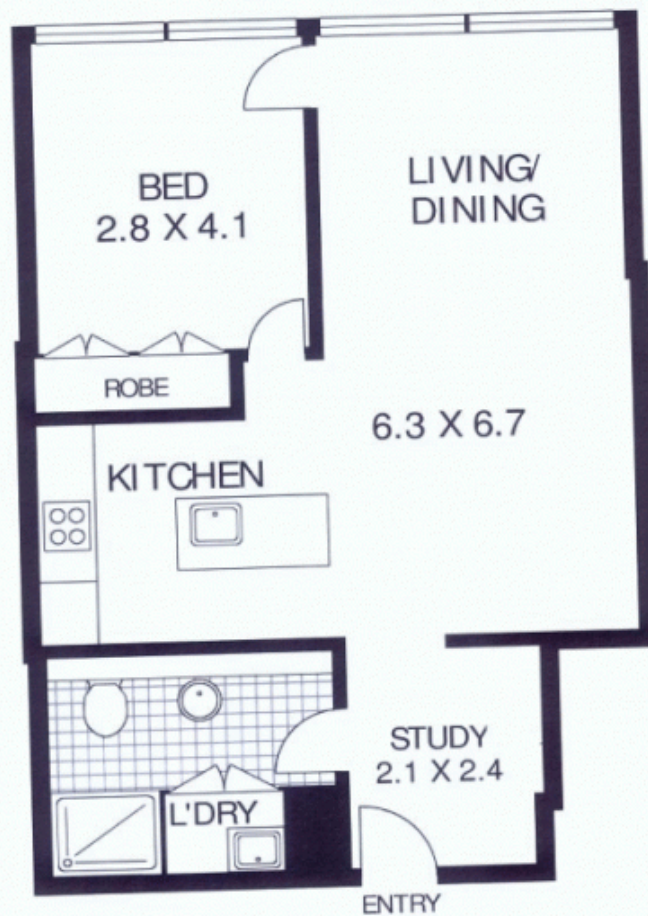

SECOND FLOOR



**217/ 49 SHELLEY STREET**

**SYDNEY**

**SCAPE Floor Planning Disclaimer:** This floor plan is conceptual only. It is provided for illustrative purposes only and should not be relied upon. We make no guarantee as to the correctness of this plan. All interested parties should make and rely on their own enquiries in determining the accuracy of the information contained in this floor plan.

Water Rates: \$142p/q approx  
Council Rates: \$201p/q approx  
Strata Rates: \$1369p/q approx

All information contained herein is gathered from sources we believe to be reliable, however we cannot guarantee its accuracy and interested persons should rely on their own enquiries.