



**morton.**

**Woolloomooloo** 445/6 Cowper Wharf Roadway

 1  1

This unfurnished east facing apartment is located on level 4 offering an abundance of natural light, with the floor to ceiling windows maximising water views from the living room and main bedroom. The flexible living space is open plan with plenty of room for living and dining.

- Waterfront views overlooking Garden Island and Potts Point
- Kitchen with marble bench tops and gas stove
- Combined lounge/dining area, bedroom with built-ins
- Internal laundry with dryer
- Reverse cycle air conditioning

**View**

As advertised or by appointment

**Agent**

**Morton RE**



 [rentals@morton.com.au](mailto:rentals@morton.com.au)

[morton.com.au](http://morton.com.au)

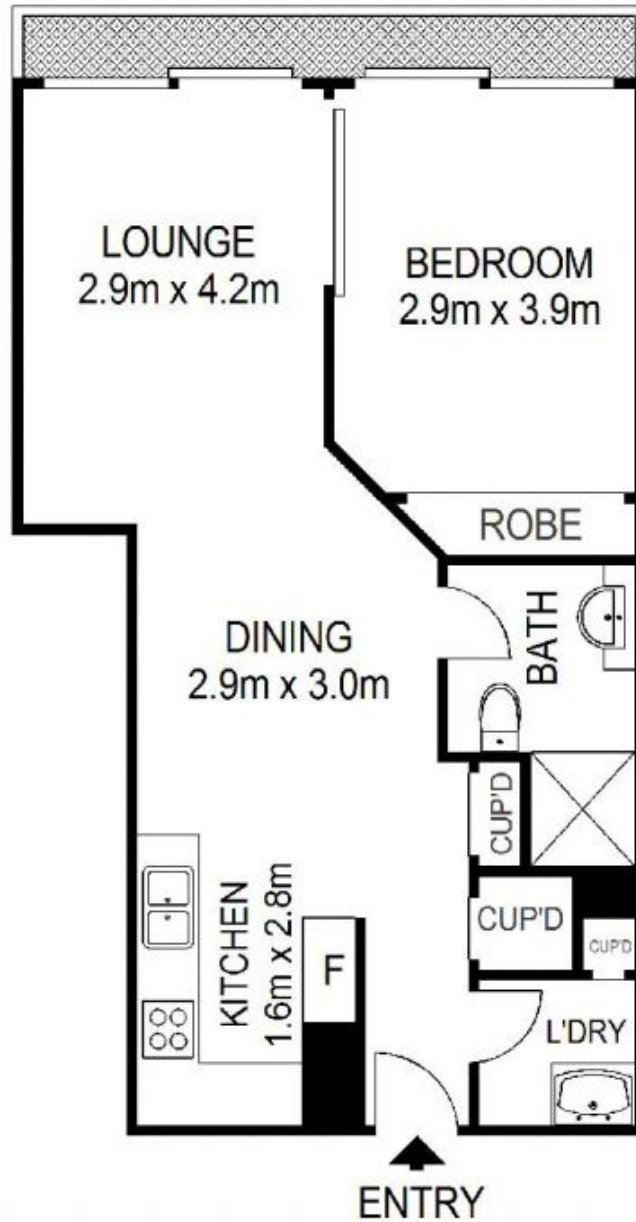

Scale shown in metres. All dimensions herein are approximate and gathered from sources believed to be reliable. Whilst every effort is made for the accuracy of our floor plans, interested parties should rely on their own enquiries. Floor Plans by Industrie Media | [industriemedia.tv](http://industriemedia.tv)

S1