



morton.

Sydney 1205/157 Liverpool Street

🛏 2 🚿 2 🚗 1

****You must register to attend an inspection, please visit www.morton.com.au search for the listing, and "Book Inspection" You will be notified if the inspection is cancelled or if the time changes****

Only a privileged few will enjoy a private view as spectacular as this. A sweeping and uninterrupted outlook over glorious Hyde Park and Sydney Harbour, surrounded by the vivid city skyline. Here lies the opportunity to be one of them with this stunning luxury residence. A coveted corner apartment on the 12th floor of 'The Hyde', synonymous with elegance and esteemed as Hyde Park Precinct's finest residential tower.

- Sun blessed, north facing aspect with views throughout
- Superb 118sqm layout including 2 bedrooms + study
- Pristine interiors flow out to the contemporary balcony/sunroom
- Spacious open plan lounge, dining and gourmet kitchen
- Both bedrooms with built-ins, master bed with luxury ensuite
- Well appointed main bathroom and separate internal laundry

View

As advertised or by appointment

Agent

Morton RE

📞
✉ rentals@morton.com.au

morton.com.au

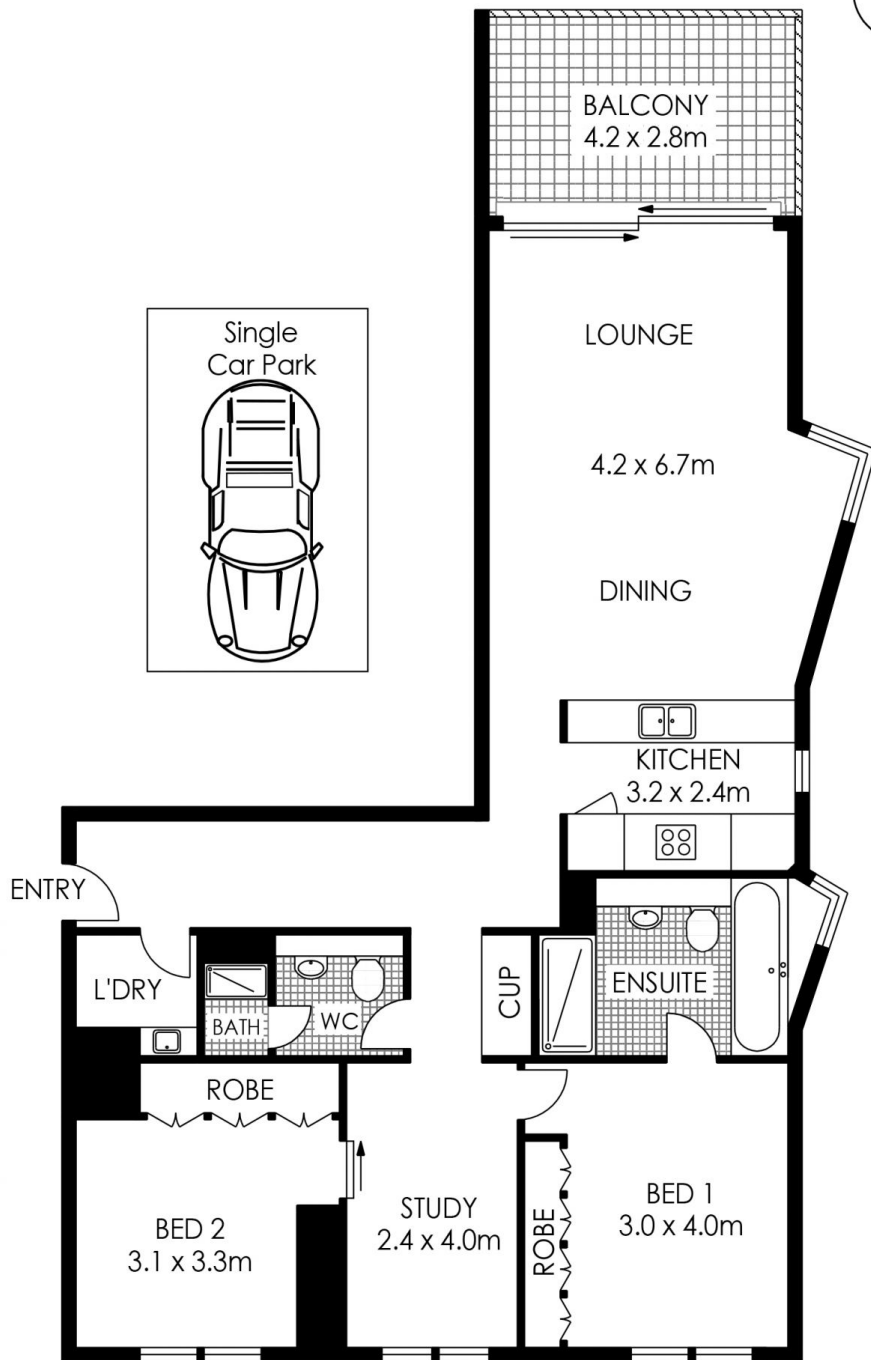

1205/157 Liverpool Street, Sydney

The information above is provided in good faith and has been provide to us from a variety of sources. We have not verified whether the information is accurate and do not have any belief one way or other in its accuracy. We do not accept any responsibility to any person for its accuracy and do no more than pass it on. All interested parties should rely on their own inquiries in order to determine whether or not this information is in fact accurate.