



# morton.

**SYDNEY** SYDNEY

 2  2

\*\*\*Inspection times are available. To be notified of the inspection times via email or SMS (free of charge), simply submit an enquiry here with your contact details. Alternatively please search for the listing on our website <http://www.mortonandmorton.com.au/6639333> to book your own inspection online.\*\*\*

This is a wonderful chance to secure a top floor, north facing executive two bedroom apartment located at the prestigious King Street Wharf development. This apartment's practical design allows for great ventilation and offers complete privacy, with sparkling harbour vistas spanning from Pymont across to Balmain.

- Sun soaked living area with plenty of natural light
- Large private balcony, floor to ceiling glass
- Spacious double bedrooms with built ins, master with ensuite
- Sleek kitchen is finished with high quality appliances
- Designer bathroom has a concealed laundry with dryer
- Security building, audio visual intercom and security access

[morton.com.au](http://morton.com.au)

### View

As advertised or by appointment

### Agent

**Morton RE**

   
 [rentals@morton.com.au](mailto:rentals@morton.com.au)

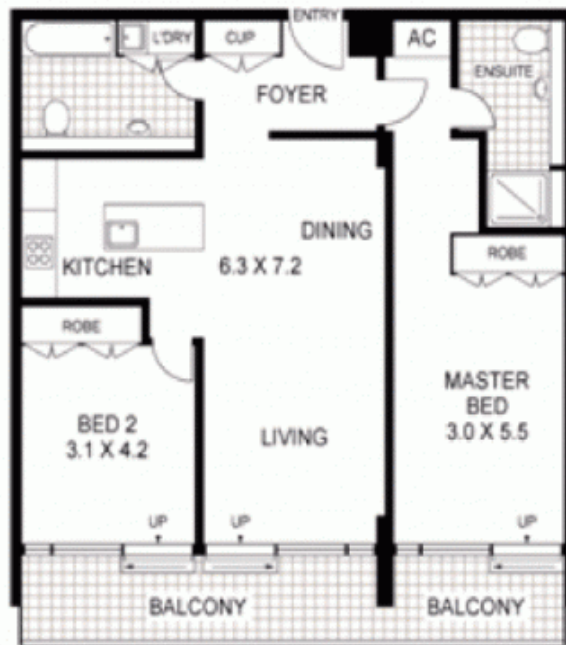

805/45 SHELLEY STREET

SYDNEY

Floor Plan Disclaimer: Mind the Gap (mkg) floor plans / site plans are intended as a guide only. No representations or warranties of any nature whatsoever are given or intended and any person using this information should always rely on their own enquiries. mkg property marketing services - 1300 133 145 - photography floor plans virtual tours video tours supporting project marketing - www.mindthegap.com.au

MORTON & MORTON