



morton.

CREMORNE 7/5 Sutherland Street

 2  1  1

A truly unique and rare opportunity to reside in this stunning apartment. Located proudly in the heart of Cremorne with breath taking views of Middle Harbour. This waterfront abode is bathed in natural sunlight, wrapped in windows that encapsulate the incredible water views.

- Spacious open living/ dining area w/ floor to ceiling windows
- Huge balcony with the spectacular harbour back drop
- Modern kitchen with granite benchtops
- Two oversized bedrooms both with built-ins
- Modern bathroom, bath, shower & separate W.C.
- Security building with lift access, intercom
- Single undercover parking

View

As advertised or by appointment

Agent

Morton RE



 rentals@morton.com.au

morton.com.au

7 / 5 SUTHERLAND ST CREMORNE

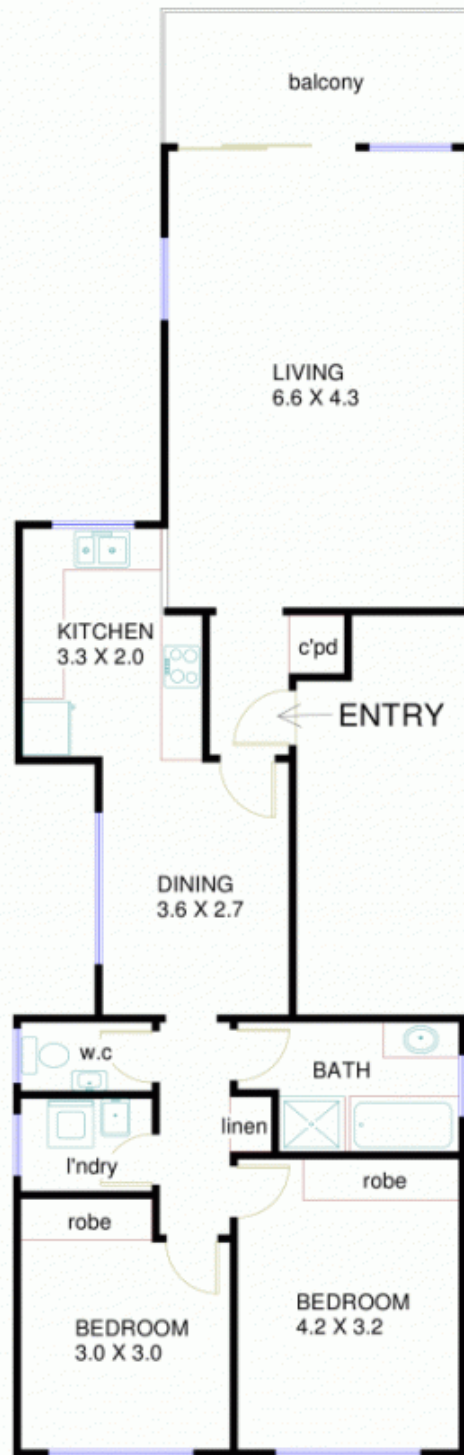

CARPORT
(not shown)

TOTAL AREA
approx. 102.7 sqm

FLOOR PLAN
ALL DIMENSIONS AND LAYOUT
ARE APPROXIMATE ONLY