



morton.

SYDNEY SYDNEY

 2  2  1

This stunning two bedroom apartment in "The Quay" Captures the essence of luxury in arguably the best Harbour front location in Sydney.

With spectacular views of the Harbour Bridge and the Botanic Gardens from every room. Awash with northerly sun all day and marble flooring throughout this apartment is designed for those who wish to live and entertain in true style.

- Formal entrance
- Two bedrooms
- Open plan kitchen
- Large Laundry
- Security parking

Building features indoor pool, spa, squash court, gym and concierge

Located in Circular Quay this is the ultimate harbour address

morton.com.au

View

As advertised or by appointment

Agent

Morton RE



 rentals@morton.com.au

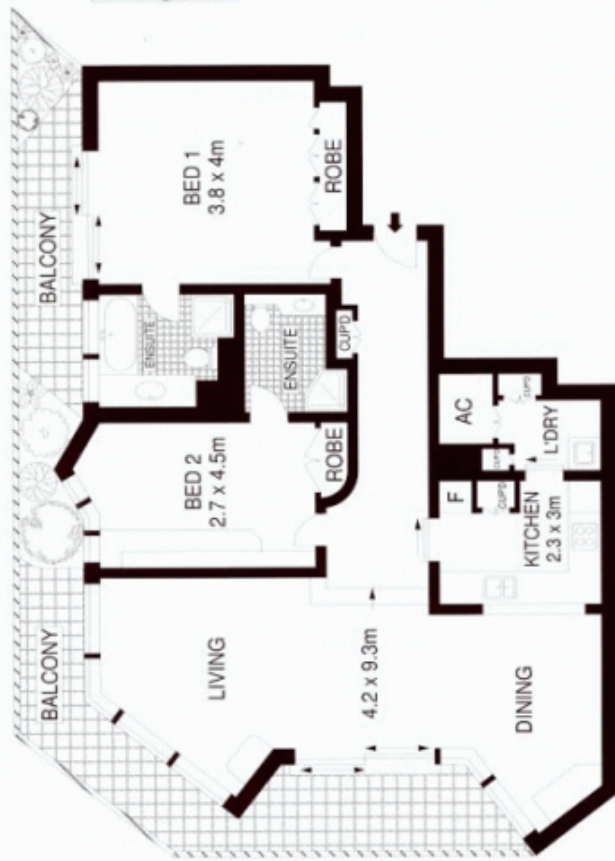

1 J2/2 PHILLIP STREET

SYDNEY