

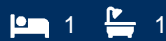

# morton.

Chippendale 708/5 Park Lane



Located in the near new 5 star Central Park complex, this fully furnished one bedroom apartment offers executive life style with convenience. Features include:

- Sleek modern kitchen with gas cooking and dishwasher
- Enclosed alfresco style balcony, perfect for all year round use.
- Carpeted main bedroom and with built ins.
- Over sized en suite bathroom and separate internal laundry with washing machine and tumble dryer provided.
- Fully furnished, move straight in.
- Access to fully equipped gymnasium and swimming pool.
- 24 hour concierge

### View

As advertised or by appointment

### Agent

**Morton RE**



rentals@morton.com.au

[morton.com.au](http://morton.com.au)



The interior style and design of this floor plan is designed for inspiration purposes to show the living spaces. It is not an exact replica of the furniture and fittings in the home.

Produced by **DIAKRIT**

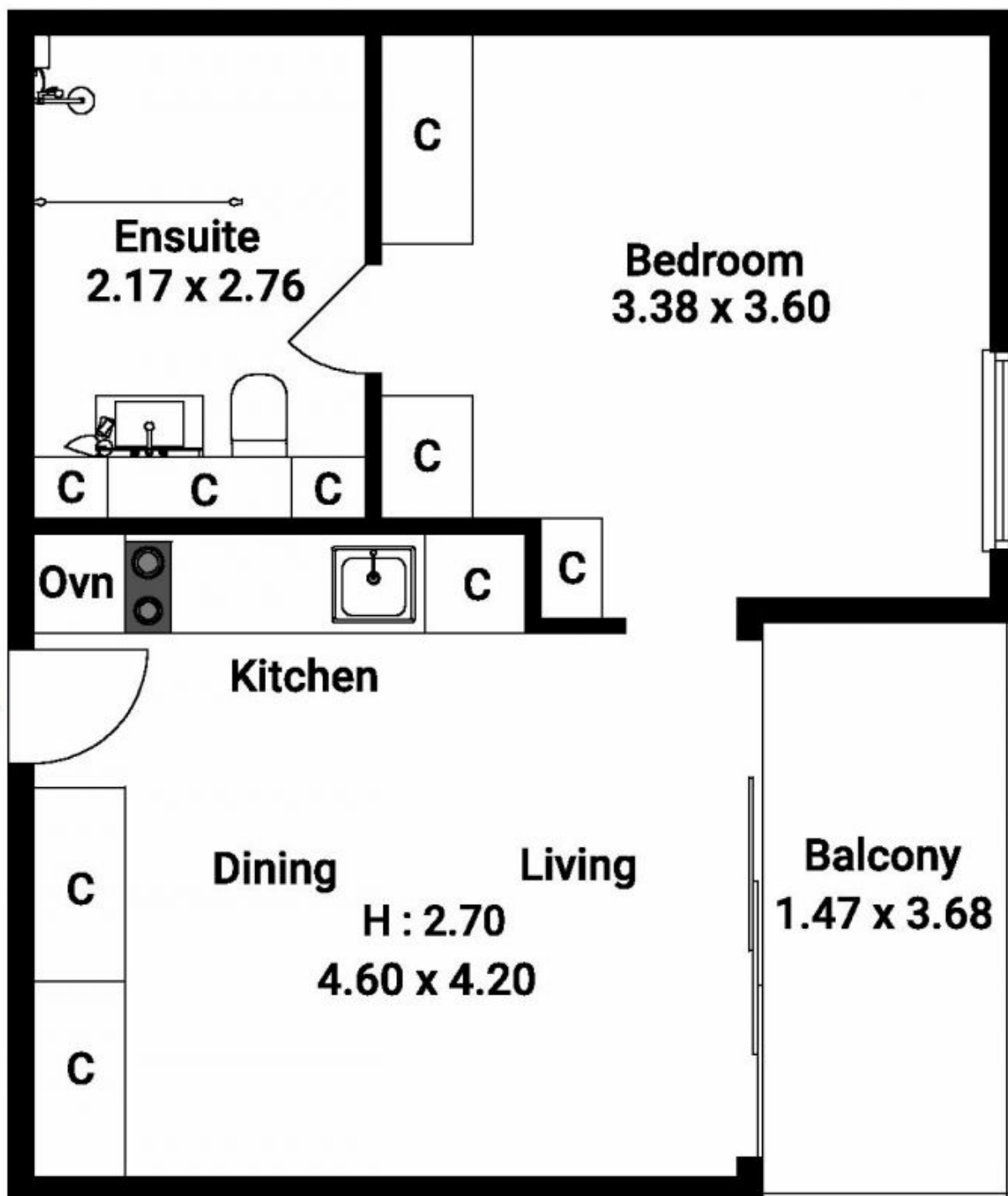

The floor plan is not to scale. Measurements are indicative and in metres.