



morton.

Woolloomooloo 130/6 Cowper Wharf Roadway

 1  1

With respect to the government's restrictions around open homes and to help stop the spread of COVID-19, our properties can be viewed by appointment only. Please contact the listing agent for more information.

A unique opportunity to secure a sought after level one terrace apartment at the renowned Finger Wharf at Woolloomooloo. This apartment features a wonderful deck which is great for weekend lunches and evening drinks by the water. Boasting expansive 180 degree water views of Garden Island and Potts Point, could there be a better start and end to the day.

- Generous sized living area and outdoor terrace
- Wooden floors throughout
- CaesarStone gas kitchen with stainless steel appliances
- Built-in wardrobes and ensuite
- Internal laundry
- Reverse cycle air conditioning
- Car space can be arranged for an extra cost

morton.com.au

View

As advertised or by appointment

Agent

Sarah Fowell



 sarah@morton.com.au

130/6 Cowper Wharf Road, WOOLLOOMOOLOO

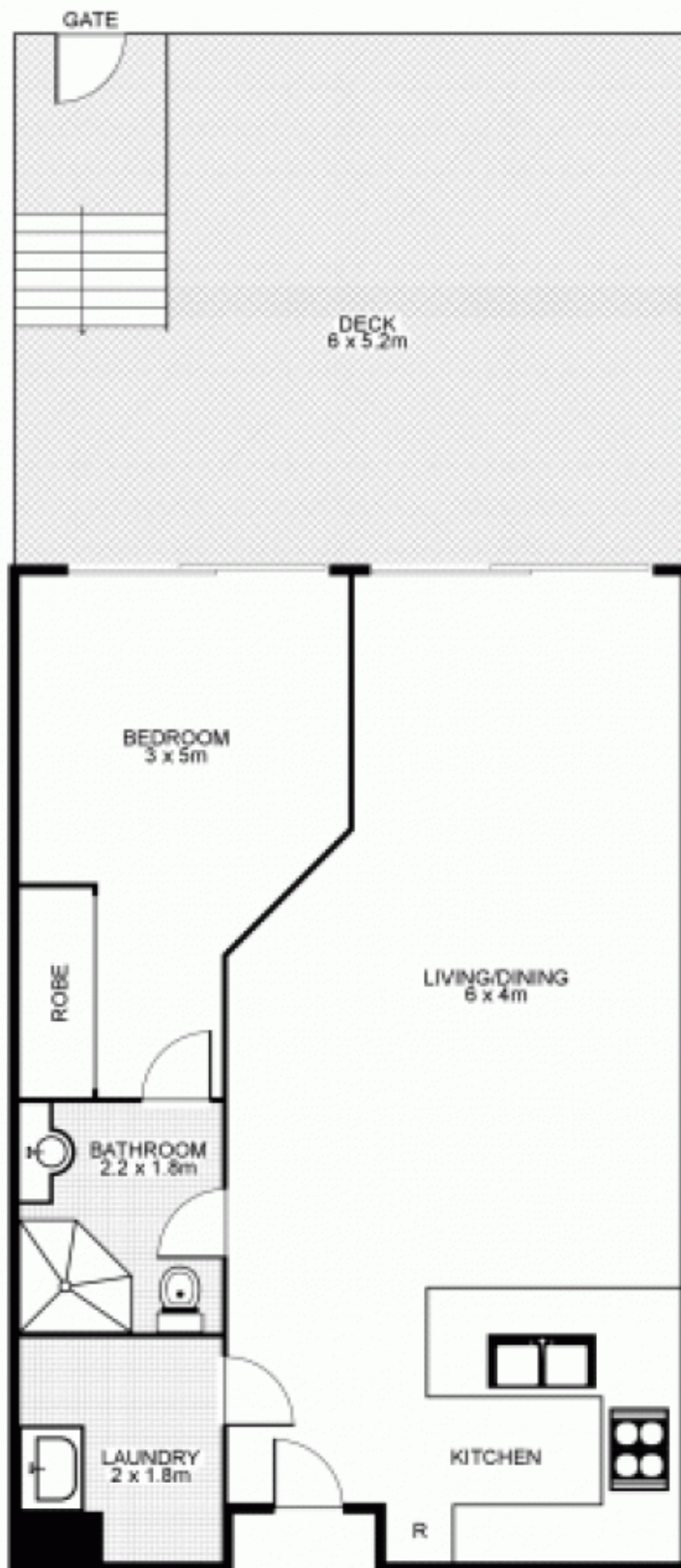

Plans by
surroundpix
com.au
1300 30 32 40

This floor plan is intended as a guide only. Layout dimensions are approximate only. No representation or warranties of any nature whatsoever are given or intended. Any person using this information should rely on their own enquiries.