



**morton.**

**Woolloomooloo** 445/6 Cowper Wharf Roadway



With respect to the government's restrictions around open homes and to help stop the spread of COVID-19, our properties can be viewed by appointment only. Please contact the listing agent for more information.

This unfurnished east facing apartment is located on level 4 offering an abundance of natural light, with the floor to ceiling windows maximising water views from the living room and main bedroom. The flexible living space is open plan with plenty of room for living and dining.

- Waterfront views overlooking Garden Island and Potts Point
- Kitchen with marble bench tops and gas stove
- Combined lounge/dining area
- Bedroom with built-ins
- Internal laundry
- Reverse cycle air conditioning

**View**

As advertised or by appointment

**Agent**

**Sarah Fowell**



sarah@morton.com.au

**morton.com.au**

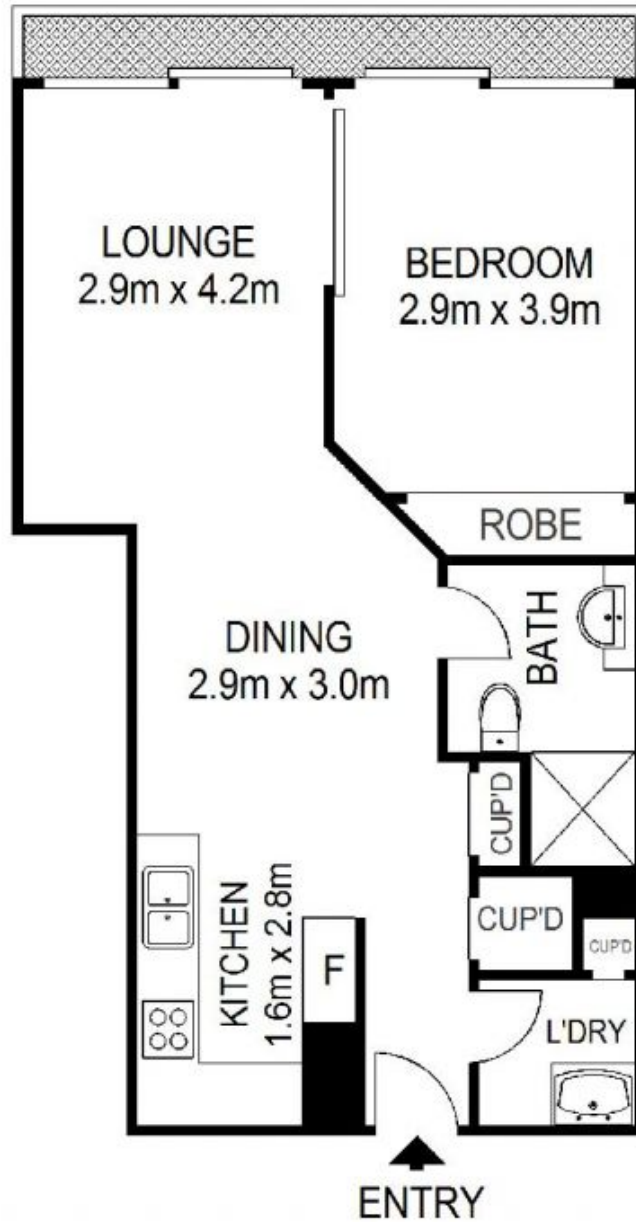

Scale shown in metres. All dimensions herein are approximate and gathered from sources believed to be reliable. Whilst every effort is made for the accuracy of our floor plans, interested parties should rely on their own enquiries. Floor Plans by Industrie Media | [industriemedia.tv](http://industriemedia.tv)

S1