

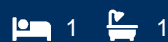

# morton.

Woolloomooloo 340/6 Cowper Wharf Roadway



This unfurnished one bedroom apartment is positioned on the historic level 3 in the private residential section of the Woolloomooloo Finger Wharf with eastern views towards Potts Point and Garden Island. High ceilings and the original Wharf's beams and braces are features that make this apartment stand out.

- Kitchen with gas cooktop and dishwasher
- Combined lounge/dining area
- Reverse cycle air conditioning
- Internal laundry
- Spacious bedroom with built-in robes
- 24 hour security
- More photos to come

### View

As advertised or by appointment

### Agent

**Sarah Fowell**



✉ sarah@morton.com.au

[morton.com.au](http://morton.com.au)

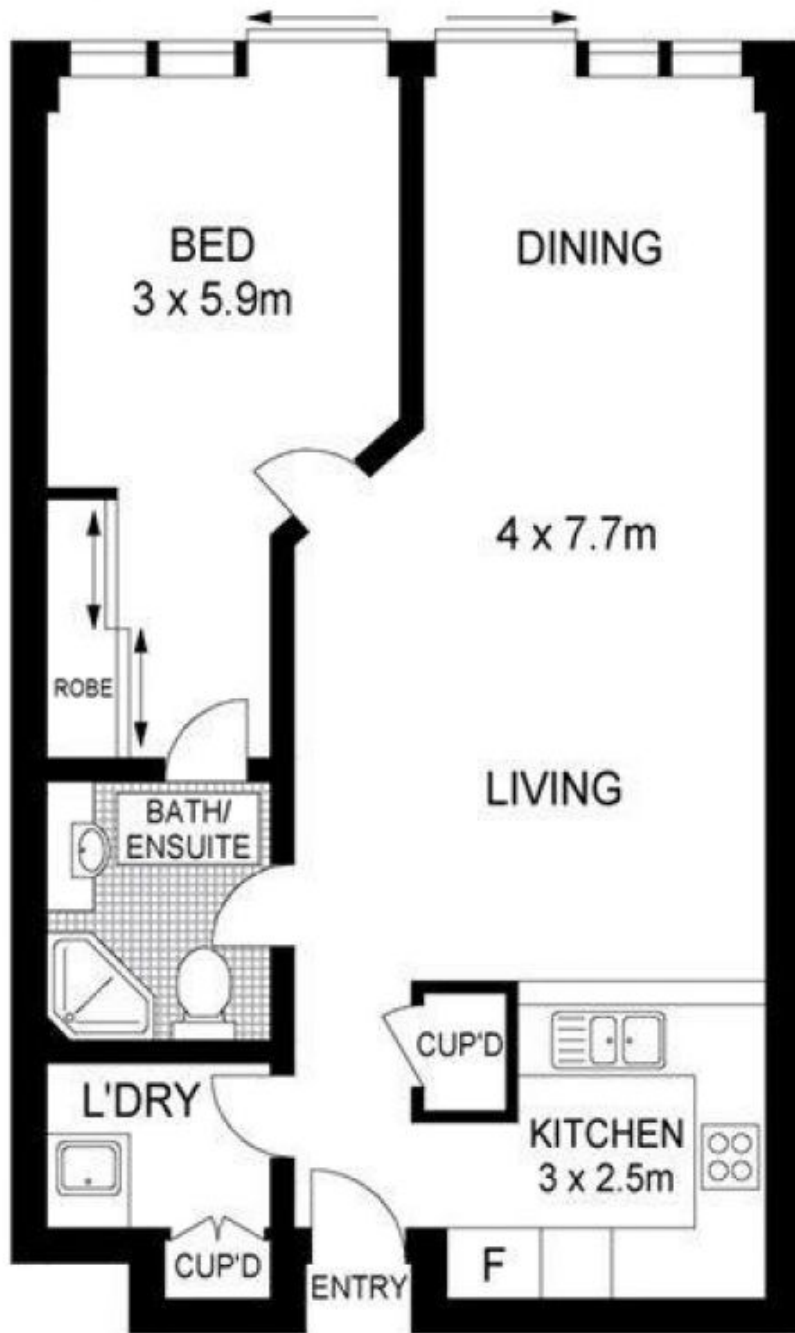

## LEVEL THREE



340/6 COWPER WHARF ROAD

WOOLLOOMOOLOO



SCALE BAR in metres

ALL INFORMATION CONTAINED HEREIN IS GATHERED FROM SOURCES WE BELIEVE TO BE RELIABLE. HOWEVER WE CANNOT GUARANTEE ITS ACCURACY AND INTERESTED PERSONS SHOULD RELY ON THEIR OWN ENQUIRIES. DIMENSIONS ARE APPROXIMATE