



# morton.

WOOLLOOMOOLOO 201/76-88 Crown Street

🏠 1 📄 1

Posing ultimate convenience and benefiting from stylish interiors, this urban sanctuary will redefine your notion of contemporary, inner city living. 'Edo' is an outstanding residential building with impact, intelligence and the last word in luxury and comfort.

- Large open plan living with fresh interiors
- Bathed in natural light, entertainers balcony
- Bedroom with built in storage, linear design
- Designer bathroom, deluxe gas kitchen
- Zonal air conditioning, internal storage
- Open outlook, city views, corner position
- Internal laundry with dryer included
- Stroll to cafes, wine bars and culinary options
- Brisk walk to Hyde park, rapid access to the CBD

### View

As advertised or by appointment

### Agent

**Morton RE**



rentals@morton.com.au

[morton.com.au](http://morton.com.au)

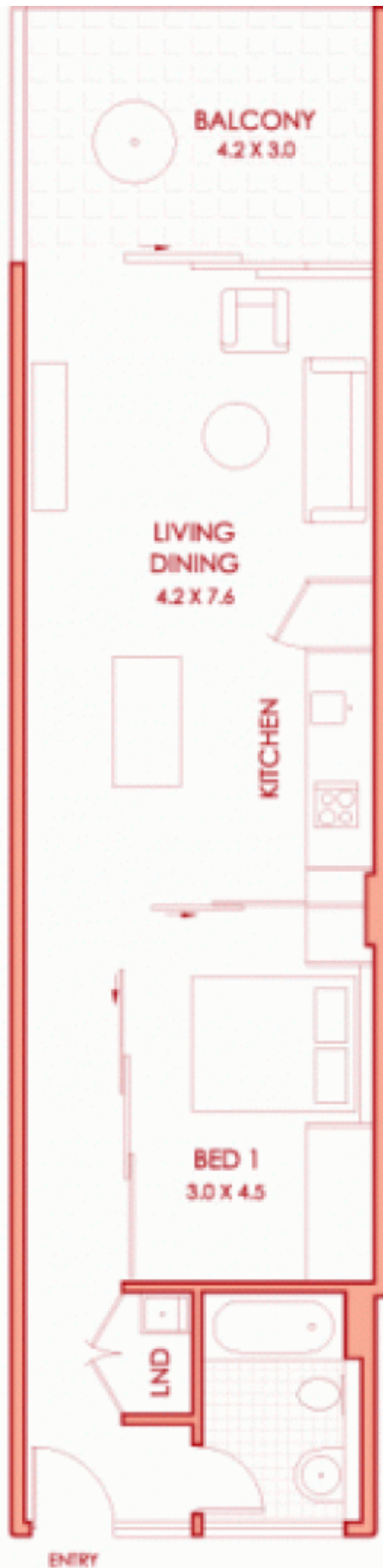

ENTRY

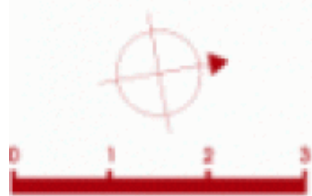

We believe the information in this document to be reliable, however interested persons should make