



# morton.

**Pyrmont** 405/8 Distillery Drive

 2  2  1

Wrapped in a huge north west facing balcony this sought-after apartment location combines luxurious ultra-contemporary interiors with resort style leisure facilities. The perfect executive address drenched in all-day sunlight, it delivers the ultimate in effortlessly idyllic waterfront living metres from acclaimed restaurants and vibrant village cafes.

- Double bedrooms with built in wardrobes
- Gourmet granite gas kitchen with Smeg appliances
- Deluxe modern bathrooms with floor to ceiling glass
- Master room with en-suite and separate bath tub
- Large laundry, ducted air and audio visual intercom
- Pool, gym, sauna, spa and two all weather tennis courts
- Secure parking and 24 hr security
- Stroll to the CBD, Darling Harbour and lush waterfront parks

### View

As advertised or by appointment

### Agent

**Morton**



 [info@morton.com.au](mailto:info@morton.com.au)

[morton.com.au](http://morton.com.au)

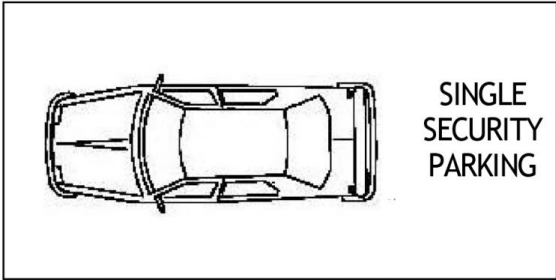

STORAGE CAGE  
4 SQM

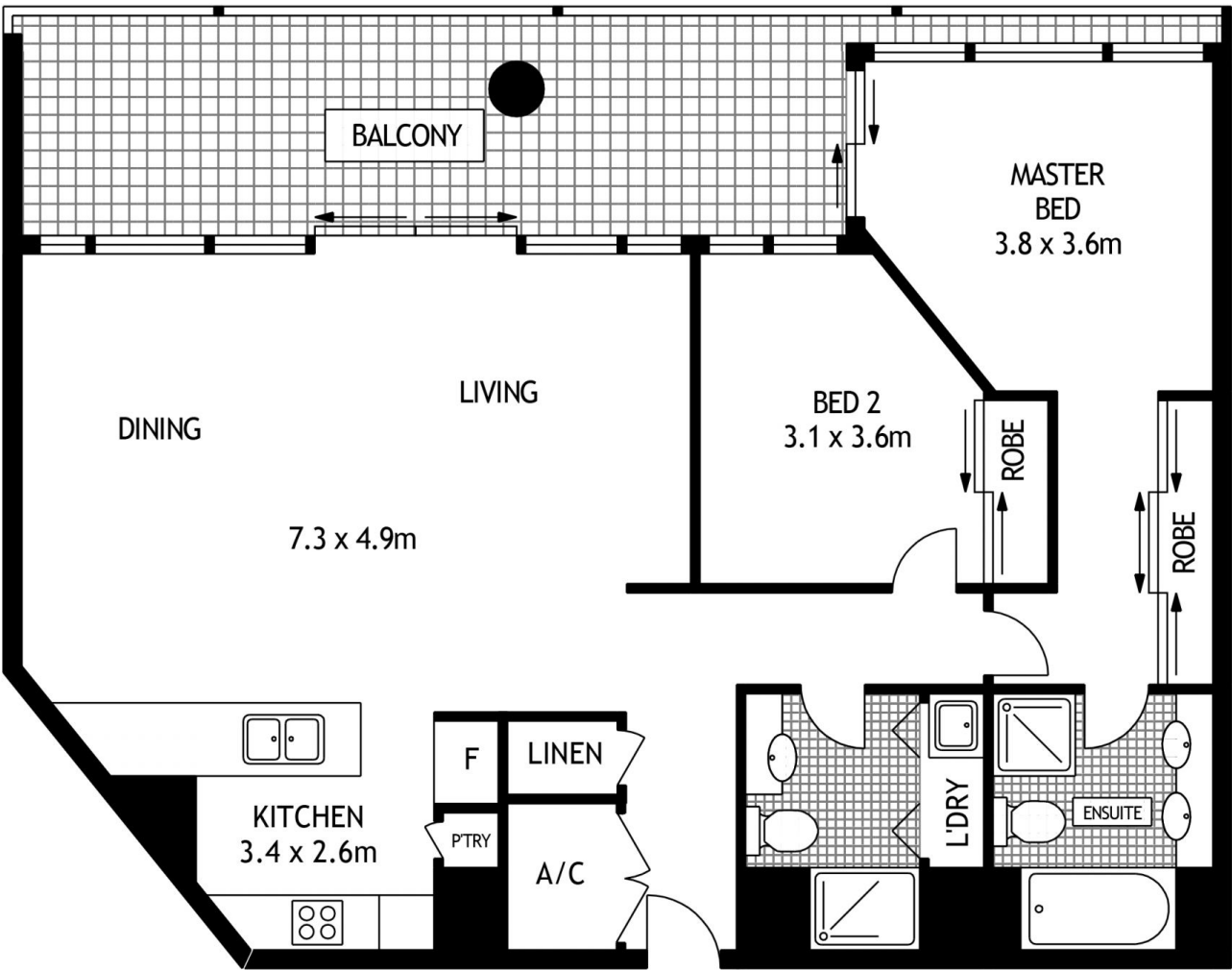

ENTRY



FOURTH FLOOR

405/8 DISTILLERY DRIVE

PYRMONT

SCAPE Floor Planing Disclaimer: This floor plan is conceptual only. it is provided for illustrative purposes only and should not be relied upon. We make no guaranteeas to the correctness of this plan. All interested parties should make and rely on their own enquiries in determining the accuracy of the information contained in this floor plan.