



morton.

Rozelle 47-51 Lilyfield Road

 2  2  1

*** Inspection times are available to be booked. ***

To book or be advised of inspection times, simply click the 'book inspection' button or send an enquiry through this website. Inspections can also be booked at <http://morton.com.au/renting/>

View

As advertised or by appointment

Agent

Morton RE



 rentals@morton.com.au

Featuring superbly stylish and luxe finishes throughout with an emphasis on spacious modern living is this exceptional brand new 2.5 bedroom apartment.

- Brand new quality fixtures and finishes
- Huge 126sqm floor plan
- Two balconies, one with water and CBD glimpses
- North facing open plan living, with timber floors
- Gourmet kitchen, Calcutta stone benchtops and llve appliances
- Master bedroom, walk-in robe and ensuite
- Spacious second bedroom, with built-in robes
- Air conditioning and internal laundry with dryer
- Under cover parking space and storage cage
- Secure building, intercom and lift access

morton.com.au



EASTON
ROZELLE

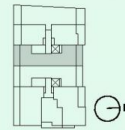

2 BEDROOM
APARTMENT 303

Internal Area	95m ²
External Area	31m ²
TOTAL AREA	126m²

EASTONAPARTMENTS.COM.AU | 1800 223 001 | ROZELLE

DESANE | CBRE

DISCLAIMER: Please note that this floor plan was produced prior to construction. The information herein is believed to be correct but is not guaranteed. Changes may be made during construction and dimensions, areas, fittings and specifications are subject to change without notice in accordance with the provisions of the contract for sale. The furniture and furnishings depicted are not included with any sale and purchasers must refer to the contract for sale for the list of inclusions. The position of furniture and furnishings should not be taken to be indicative of final positions of power points, TV connection points and the like. Prospective purchasers must rely on their own enquiries. All graphics including site layout, balconies and the like are indicative only. Buildheads for services are not depicted. Floor plan is at an unspecified scale. All area sizes indicated are approximate only and are subject to final survey.