

morton.

NEWTOWN 48/37 Iredale Street

 2  1  2

Nestled in a quiet street this New York style loft apartment will redefine your notion of relaxed but sophisticated inner city living. This ultra chic apartment is just a minutes stroll to Newtown's vibrant King Street and incorporates leading edge design, superb inclusions and an ambience of natural light and style.

- Sun drenched open plan lounge / dining with high ceilings
- Flows to large balcony with the city skyline as your backdrop
- Designer kitchen with European stainless steel appliances
- Dishwasher, stone benchtops & ample cupboard space
- Master bedroom with custom built-in wardrobes
- Bright second bedroom ideally suited as a home office

View

As advertised or by appointment

Agent

Sarah Fowell

 0437 492 129

 sarah@morton.com.au

morton.com.au

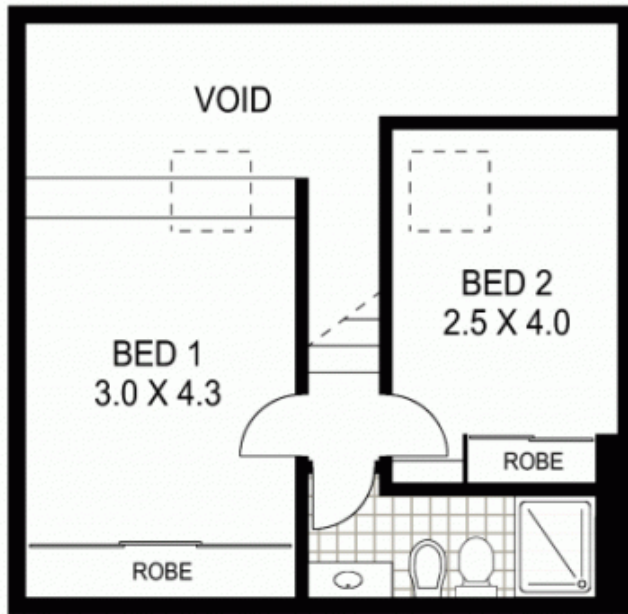

THIRD FLOOR

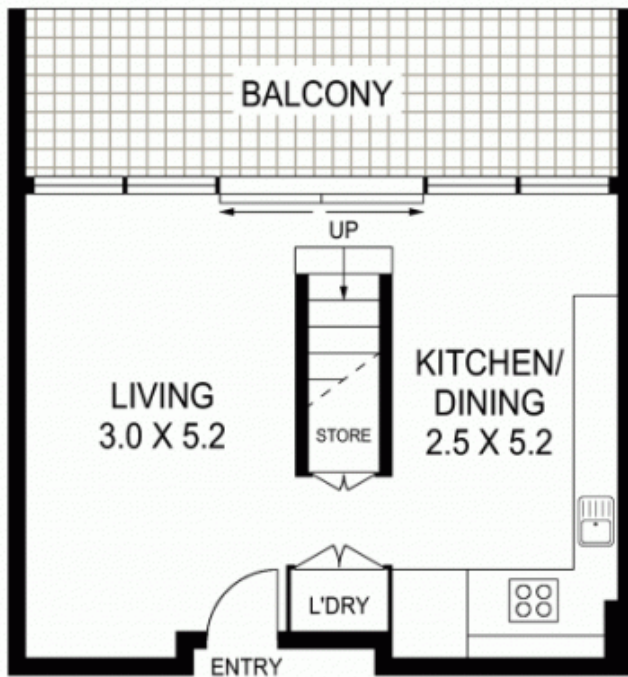

SECOND FLOOR

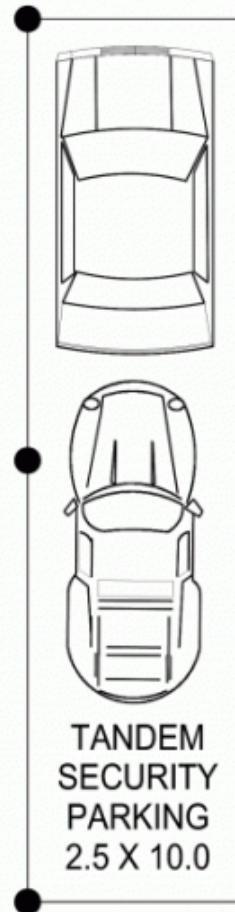

BASEMENT FLOOR

APPROX : GROSS INTERNAL AREA :- 65 SQM



48/37 IREDALE STREET

NEWTOWN

Floor Plan Disclaimer: Mind the Gap (mtg) floor plans / site plans are intended as a guide only. No representations or warranties of any nature whatsoever are given or intended and any person using this information should always rely on their own enquiries. mtg property marketing services - 1300 133 145 - photography, floor plans, virtual tours, video tours, copywriting, project marketing - www.mindthegap.com.au