



# morton.

**Wentworth Point** 353/5 Baywater Drive

 2  2  1

This is an opportunity to purchase in the vibrant Waterfront Estate. This apartment occupies an impressive north facing position with direct access to the beautifully landscaped gardens. Located in Palermo, it is very well kept and located on the ground floor.

- 137sqm terrace with gated access to landscaped podium level
- Huge living room opening on to the terrace with air conditioning
- Stainless steel appliances and stone bench top
- Extra pantry/linen cupboards and internal laundry with dryer
- Double size main and second bedrooms, both with air conditioning
- Wall to wall mirror built-in wardrobes and ensuite to master
- Two-way bathroom with access from second bedroom
- Second balcony accessed from both bedrooms
- Secure car space with storage cage and video intercom

### View

As advertised or by appointment

### Agent

**Sarah Fowell**

 0437 492 129

 [rentals@morton.com.au](mailto:rentals@morton.com.au)

[morton.com.au](http://morton.com.au)

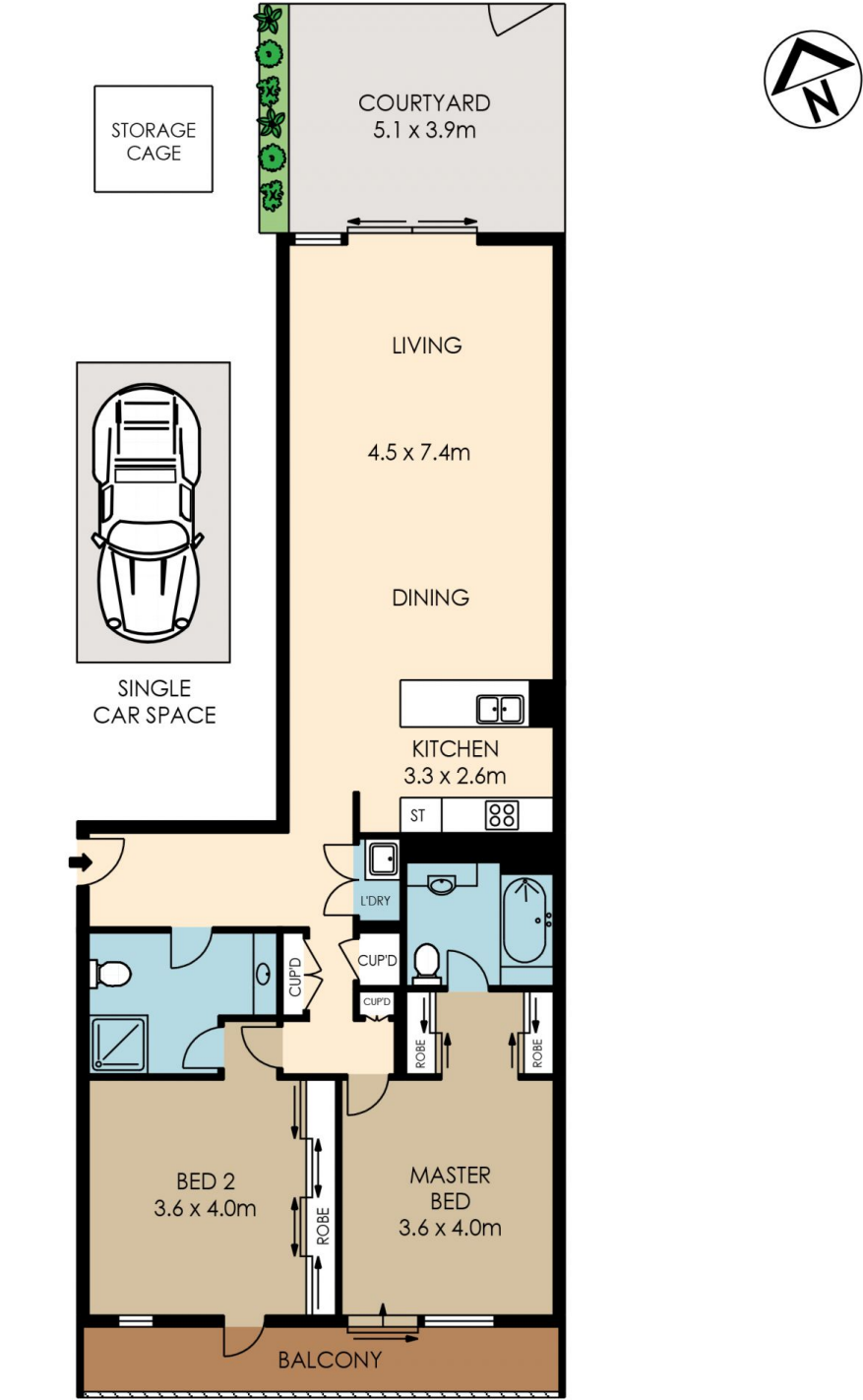

# 353/5 Baywater Drive, Wentworth Point

The information above is provided in good faith and has been provide to us from a variety of sources. We have not verified whether the information is accurate and do not have any belief one way or other in its accuracy. We do not accept any responsibility to any person for its accuracy and do no more than pass it on. All interested parties should rely on their own inquiries in order to determine whether or not this information is in fact accurate.