



morton.

Wentworth Point 852/5 Baywater Drive

 2  2  1

With an abundance of space and light this rarely offered floorplan is truly one of the finest in Wentworth Point. Its north facing top floor position with part double height ceilings and expansive terrace overlooking the communal gardens represents an opportunity not to be missed.

- Large lounge dining with direct access to spacious north facing balcony
- Fitted kitchen with island stone bench tops and stainless steel appliances
- Large master bed ensuite with bathtub and walk-in robes
- Sizable second bedroom with built-ins and a second bathroom
- Internal laundry with dryer and storage throughout
- Large single car space with separate storage cage and audio/visual intercom
- Short walk to bus stop, ferry services and soon to be open Homebush Bay Bridge
- Close to The Piazza and Newington Shopping Village with an array of cafes and restaurants

morton.com.au

View

As advertised or by appointment

Agent

Sarah Fowell

 0437 492 129

 rentals@morton.com.au



- ENTRY 1
- LIVING 2
- DINING 3
- KITCHEN 4
- MAIN BEDROOM 5
- ENSUITE 6
- BEDROOM 2 7
- BATHROOM 8
- LAUNDRY 9
- LINEN 10
- BALCONY 11
- CLOTHES DRYING 12

LEVEL 08

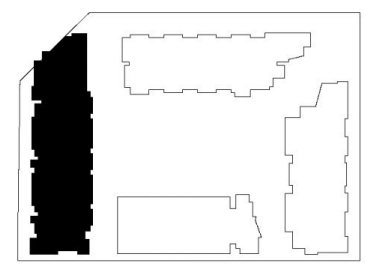

PALERMO

UNIT: **852**

TYPE: **2 Bedroom**

UNIT AREA: **106.0 sqm**

OUTDOOR AREA: **23.0 sqm**



Disclaimer: All layouts are indicative only, and subject to change.

