



# morton.

**WENTWORTH POINT** 5 Baywater Drive

 2  2  1

Exceptional floorplan, perfect North Easterly aspect, 129 sqm of living space plus outdoor pool and gym for residents of this building.

Pulse Lifestyle Club onsite with indoor heated lap pool, gymnasium, tennis courts, cafes and restaurants.

- \* Perfect presentation
- \* Two bedrooms; walk through robes
- \* Main bathroom plus ensuite
- \* Generous living area
- \* Stone benchtops, s/steel appliances
- \* Fabulous sun filled entertaining balcony
- \* Overlooking landscaped podium

Strata Levies \$ 997 pq  
Council Rates \$ 190 pq approx  
Water Rates \$ 135 pq approx

### View

As advertised or by appointment

### Agent

**Sarah Fowell**

 0437 492 129

 [rentals@morton.com.au](mailto:rentals@morton.com.au)

[morton.com.au](http://morton.com.au)



LEVEL 05

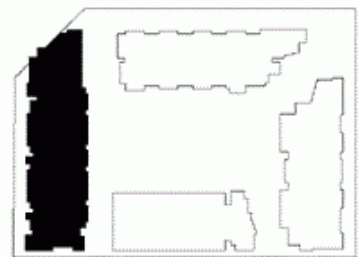

# PALERMO

UNIT: **552**

TYPE: **2 Bedroom**

UNIT AREA: **106.0 sqm**

OUTDOOR AREA: **23.0 sqm**



Disclaimer: All layouts are indicative only, and subject to change.

