



morton.

Sydney 805/209 Castlereagh Street



With an exacting attention to detail and the finest of designer finishes, this stunning apartment offers cutting-edge living for bespoke inner-city enjoyment. Only steps from Hyde Park and the best Sydney cafes, bars and restaurants on offer from your building door, 'The Castlereagh' balances both convenience and quality inner-city luxury.

- Offers excellent returns for a Sydney city Investment
- Provides a spacious, well-proportioned floor plan
- Perfect investment or CBD "home away from home"
- Flawless condition, ducted air-con, private covered balcony
- Sleek CaesarStone kitchen, premium Smeg gas appliances
- Oversized bathroom with walk-in shower, generous storage
- Engineered hardwood floors, shutout blinds and extra storage

Step out the front door and you're just a few footsteps to the best this city has to offer with the flourishing green of Hyde Park, Chinatown, QVB and a choice of bus/train stations to mention a few just moments away.

morton.com.au

View

As advertised or by appointment

Agent

Ettiene West

📞 0410 593 749

✉️ ettiene@morton.com.au

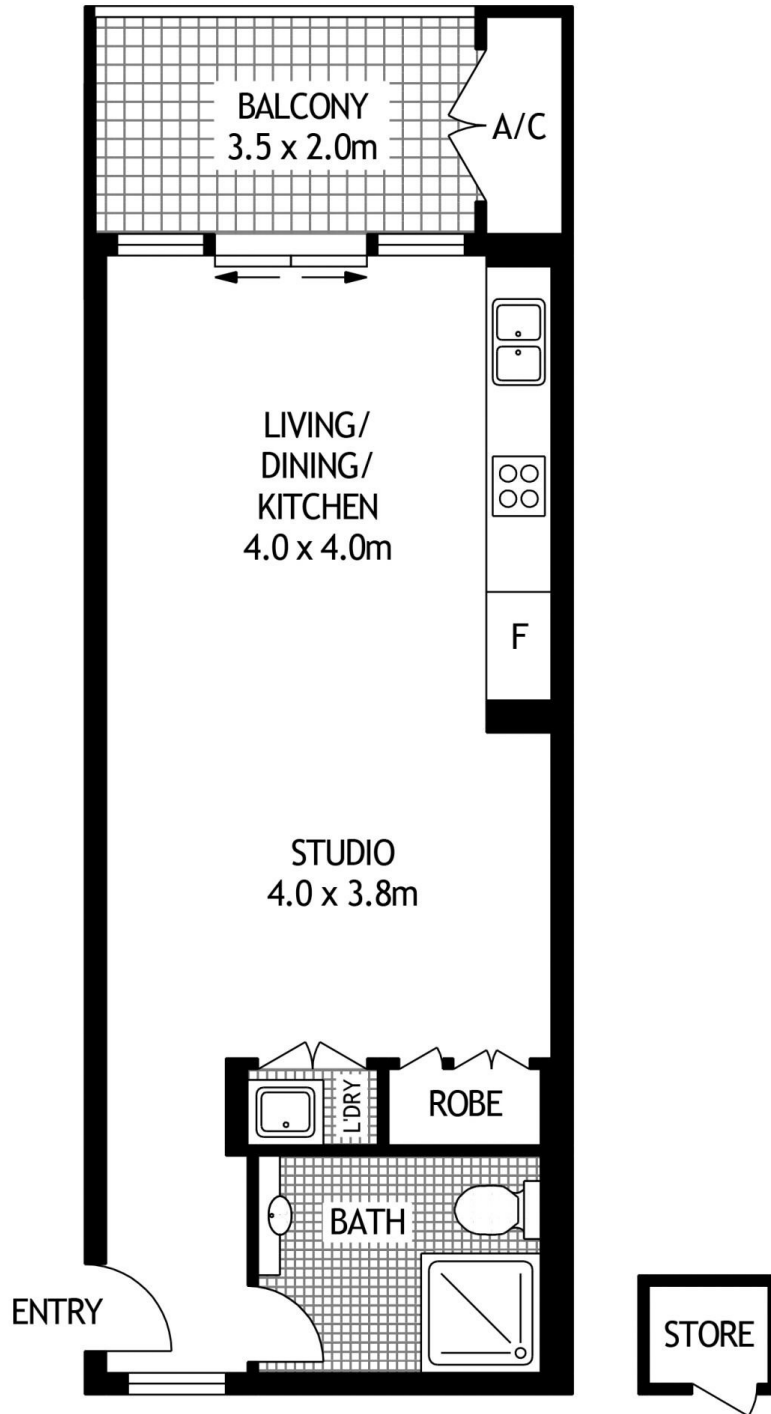

EIGHTH FLOOR



805/209 CASTLEREAGH STREET

SYDNEY

SCAPE Floor Planing Disclaimer: This floor plan is conceptual only. It is provided for illustrative purposes only and should not be relied upon. We make no guarantee as to the correctness of this plan. All interested parties should make and rely on their own enquiries in determining the accuracy of the information contained in this floor plan.