



morton.

Sydney 206/111 Harrington Street



With abundant natural light and in a great location, this suite is a fantastic offer.

The premises are only minutes away from Circular Quay and all forms of public transport. The office space is available with existing fit out and must be inspected to best appreciate the unique opportunity it offers.

- Fantastic views of Circular Quay and Sydney Opera House
- Partitioned commercial space
- Professional environment
- Good natural light
- Prime northern CBD location
- Ducted air conditioning
- Modern kitchen and bathroom facilities
- 24 hour security access
- New child care centre in the building

View

As advertised or by appointment

Agent

Sarah Fowell



sarah@morton.com.au

morton.com.au

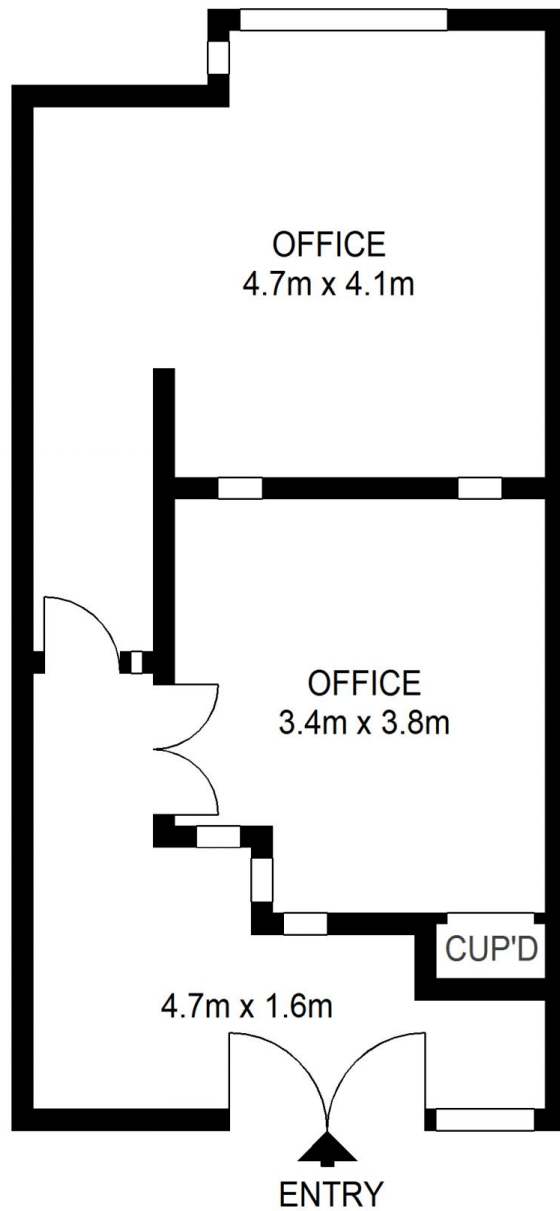

LEVEL TWO

morton.

206/ 111 Harrington Street, SYDNEY

Not to scale • All measurements are approximate • Drawn for marketing purposes only • Floorplan by © Industrie Media

