



morton.

SYDNEY 2401/157 Liverpool Street

 3  2  2

Rare to come across but always sought after, an exclusive address at 'The Hyde' is available, offering spectacular uninterrupted views over Hyde Park and Sydney harbour. Sun lit with its north aspect; this 3 bedroom apartment provides all that a luxurious and exciting inner-city lifestyle requires.

Floor-to-ceiling windows and a contemporary version of an all-weather balcony highlight the incredible outlook from this 24th floor position. This immaculately finished 141sqm apartment has a cleverly laid out floorplan, with bedrooms positioned at the rear of the residence and the spacious entertaining areas flowing freely out to capture the city and park surrounds.

Designed by award winning architects WOHA, The Hyde is one of Sydney's finest and recent developments in the Hyde Park precinct. Offering residents world-class facilities a level complete with a pool, gym, outdoor cabana and bbq area. Its central location within walking distance to the CBD, restaurants, galleries, shopping districts and transport links

View

As advertised or by appointment

Agent

Morton RE

 [info@morton.com.au](tel:)

morton.com.au

2401/157 Liverpool Street, Sydney

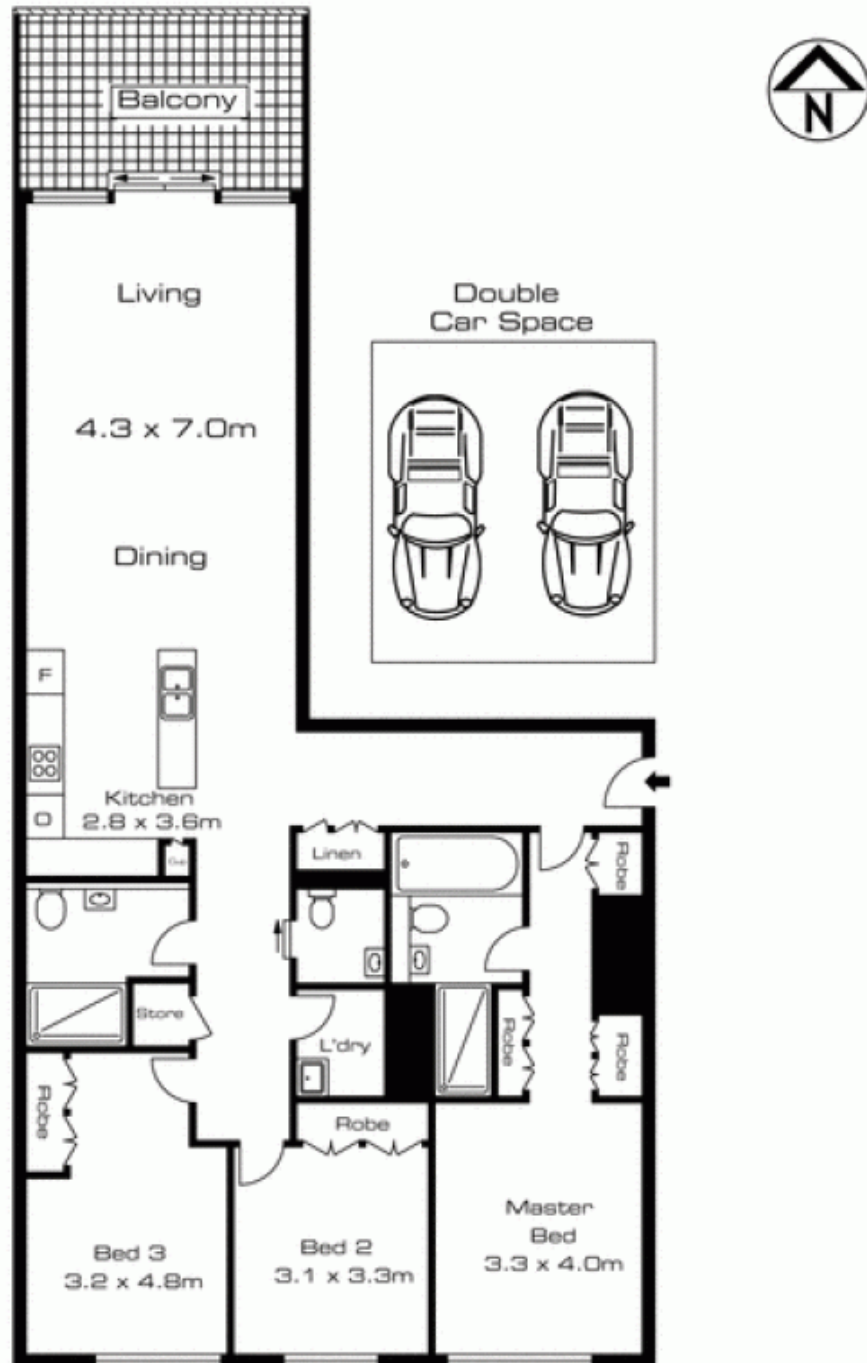

The information above is provided in good faith and has been provide to us from a variety of sources. We have not verified whether the information is accurate and do not have any belief one way or other in its accuracy. We do not accept any responsibility to any person for its accuracy and do no more than pass it on. All interested parties should rely on their own inquiries in order to determine whether or not this information is in fact accurate.